

N/F WEGG
P.I.D.#08-03-38.00

N/F SMITH
P.I.D.#08-03-41.000

N/F GLOTTMAN
P.I.D.#08-03-37.100
BK. 69/26

N/F KIENZLE & ZAHN
P.I.D.#08-03-44.000
BK. 76/257
REF. #2

N/F PHILLIPS
P.I.D.#08-03-49.000
REF. #2

MINIMUM ISOLATION DISTANCES
THE PROPOSED DRILLED BEDROCK WELL SHALL SATISFY THE FOLLOWING MINIMUM ISOLATION DISTANCES:
A. SEPTIC SYSTEMS - 100' UPSLOPE OF, 200' DOWNSLOPE OF
B. SEPTIC TANKS AND ASSOCIATED PIPING - 50'
C. DRIVEWAYS - 15'
D ALL OTHER ISOLATION AS SPECIFIED IN VERMONT WATER SUPPLY RULES, CHAPTER 21.

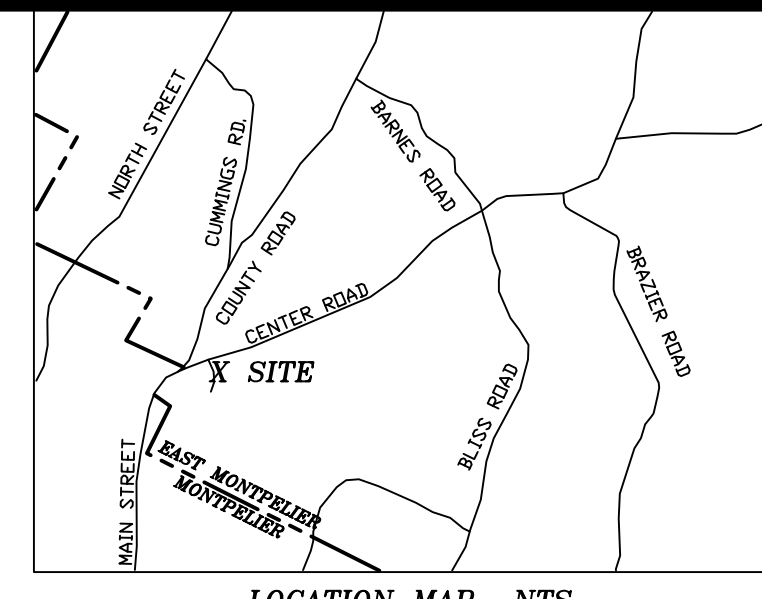

LOCATION MAP NTS

LEGEND:

- BUILDING SETBACK LIMITS±
- - - 1' INTERVAL CONTOUR (EXISTING)
- - - 5' INTERVAL CONTOUR (EXISTING)
- PROPERTY LINE ±
- ROAD RIGHT OF WAY LINE
- EASEMENT EDGE
- EDGE OF PAVEMENT
- EDGE OF GRAVEL
- OVERHEAD UTILITY LINE
- WIRE FENCE
- PROPOSED FINISHED GRADE CONTOUR
- ⊕ SOILS TEST PIT
- ⊕ PERCOLATION TEST
- ⊙ IRON ROD FOUND
- #5 REBAR SET W/ I.D. CAP
- ⊙ IRON PIPE FOUND
- ▲ UNMONUMENTED POINT
- UTILITY POLE

GRAPHIC SCALE

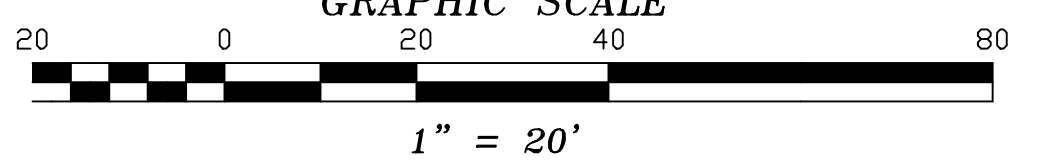

PROJECT BENCHMARK
TOP OF IRON ROD FOUND
ASSUMED DATUM
ELEVATION = 501.0'

WASTEWATER SYSTEM ISOLATION ZONE

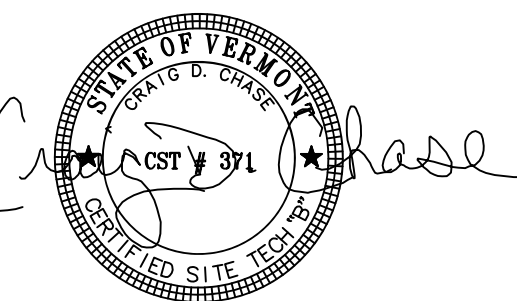

SITE PLAN
DUANE WELLS
CENTER ROAD & CUTLER HEIGHTS
EAST MONTPELIER, VERMONT

SCALE: 1"=20' | DATE: 10/14/09 | PROJ.#2009-079 | DWG.# 09079B
DRAWN BY: CDC | CHECKED BY: WRC | FB/PG. EFB | SHEET SPI

CHASE & CHASE
SURVEYORS & SEPTIC DESIGNERS INC.
301 N. MAIN ST. - BARRE, VT. 05641
(802)-479-9636