

I CERTIFY THAT THIS PLAT IS AN ORIGINAL INK ON MYLAR DRAWING. RICHARD W. BELL L.S.

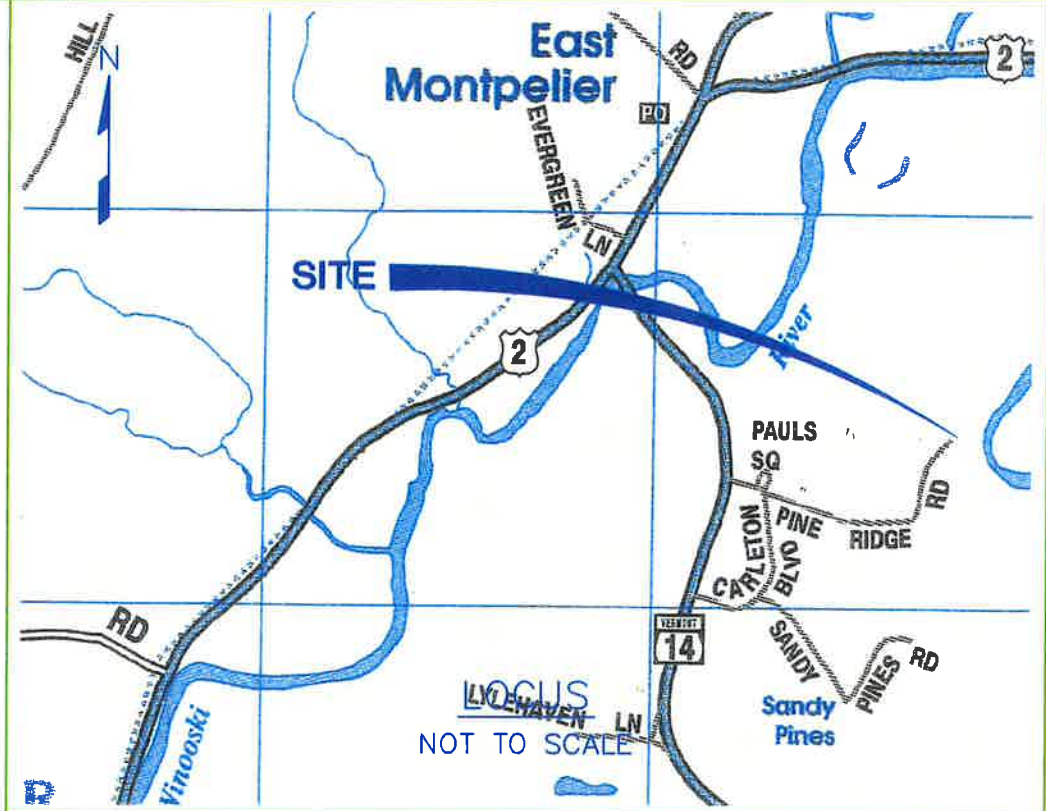

**CERTIFICATION**

I HEREBY CERTIFY THAT THE SURVEY SHOWN HEREON IS A TRUE AND CORRECT REPRESENTATION OF THE PARCEL BOUNDARIES DETERMINED AS NOTED HEREON AND IS ACCURATE TO THE BEST OF MY KNOWLEDGE AND BELIEF. THIS SURVEY WAS PERFORMED WITH ELECTRONIC TOTAL STATION SURVEY EQUIPMENT, WITH A POSITIONAL TOLERANCE CONFIDENCE LEVEL ABOVE 95%. I FURTHER CERTIFY THAT THIS PLAT MEETS ALL THE REQUIREMENTS OF TITLE 27 V.S.A. SECTION 2401.



DATED \_\_\_\_\_ W. BELL L.S. #638 VT.

© COPYRIGHT 2014

PROJ. #14787

DATE: NOV. 1987

SCALE: 1"=30'

SURVEYED BY: RWB/TWW

CHECKED BY: RWB

EXHIBIT SHOWING LOCATION  
OF WASHOUT AREA  
PINE RIDGE ROAD  
EAST MONTPELIER, VERMONT

SHEET 1 OF 1

DWG. # S-787



**RICHARD W. BELL  
LAND SURVEYING, INC.**

297 SOUTH MAIN ST.  
BARRE, VERMONT 05641

802-479-9262 C 802-793-5037  
EMAIL RBELL@BELL-LANDSURVEYOR.COM