

LEGEND

- 985 --- EXISTING CONTOUR
— 985 — PROPOSED CONTOUR
- - - - - APPROXIMATE PROPERTY LINE
- · - · - APPROXIMATE SETBACK LINE
- - - - - APPROXIMATE EASEMENT LINE
— SS — APPROXIMATE GRAVITY SEWER LINE
— FM — APPROXIMATE SEWER FORCE MAIN
— ST — APPROXIMATE STORM DRAINAGE LINE
— W — APPROXIMATE WATER LINE
— OE — APPROXIMATE OVERHEAD ELECTRICAL LINE
— UE — APPROXIMATE UNDERGROUND ELECTRICAL LINE
— G — APPROXIMATE GAS LINE
— x — x — FENCE
- - - - - DRAINAGE SWALE/DITCH
~ ~ ~ ~ ~ APPROXIMATE EDGE OF WOODS
DECIDUOUS TREE
CONIFEROUS TREE
SHRUB/PLANTING
SEWER MANHOLE
DRAINAGE MANHOLE
DRAINAGE CATCH BASIN
DRILLED WELL
POWER POLE
GUY WIRE
LIGHT POLE
SIGN POST
IRON PIPE/ROD FOUND/SET
CONCRETE MONUMENT FOUND/SET
PROJECT BENCHMARK

SEE NOTE 12, SHEET C2.0

GENERAL NOTES

- 1) UTILITIES SHOWN DO NOT PURPORT TO CONSTITUTE OR REPRESENT ALL UTILITIES LOCATED UPON OR ADJACENT TO THE SITE SHOWN. EXISTING UTILITIES SHOWN ARE APPROXIMATE ONLY. THE CONTRACTOR SHALL CONTACT DIGSAFE (888-344-7233) PRIOR TO CONSTRUCTION, FIELD VERIFY ALL UTILITY CONFLICTS AND REPORT THEM TO THE DESIGNER. ANY EXISTING UTILITIES NOT INCORPORATED INTO THE FINAL DESIGN SHALL BE REMOVED OR ABANDONED AS INDICATED ON THE PLANS OR AS DIRECTED BY THE ENGINEER.
- 2) THE CONTRACTOR SHALL CONTACT THE ENGINEER PRIOR TO THE COMMENCEMENT OF WORK AND SHALL COORDINATE ALL REQUIRED INSPECTIONS.
- 3) THE CONTRACTOR IS RESPONSIBLE FOR SAFE CONSTRUCTION OPERATIONS AND SHALL CONFORM TO ALL APPLICABLE REGULATIONS FOR SITE SAFETY.
- 4) THE CONTRACTOR IS RESPONSIBLE FOR INSTALLING AND MAINTAINING ALL APPLICABLE EROSION CONTROL MEASURES. REFER TO THE MOST RECENT PUBLICATION OF THE STATE OF VERMONT EROSION CONTROL HANDBOOK.
- 5) THE CONTRACTOR SHALL NOTIFY THE DESIGNER OF ANY SITE CONDITIONS NOT REPRESENTED ON THE PLANS THAT INFLUENCE THE CONSTRUCTION OF THE PROPOSED IMPROVEMENTS.
- 6) THE CONTRACTOR SHALL REPAIR ALL DISTURBED AREAS AS A DIRECT OR INDIRECT RESULT OF THE CONSTRUCTION TO THEIR ORIGINAL CONDITIONS. ALL GRASS LAWN AREAS SHALL BE MAINTAINED UNTIL PERMANENT VEGETATION IS ESTABLISHED. MAINTAIN ALL TREES OUTSIDE OF THE CONSTRUCTION LIMITS.
- 7) THE CONTRACTOR SHALL BE RESPONSIBLE FOR ALL WORK NECESSARY FOR COMPLETE AND OPERABLE FACILITIES AND UTILITIES.
- 8) THE CONTRACTOR SHALL SUBMIT SHOP DRAWINGS FOR ALL ITEMS AND MATERIALS INCORPORATED INTO THE SITE WORK AND UTILITIES. WORK SHALL NOT COMMENCE ON ANY ITEM UNTIL SHOP DRAWING APPROVAL IS GRANTED.
- 9) IN ADDITION TO THE REQUIREMENTS IN THESE PLANS, THE CONTRACTOR SHALL COMPLETE THE WORK IN ACCORDANCE WITH ALL LOCAL AND STATE PERMIT CONDITIONS, AS WELL AS THE MOST RECENT EDITION OF THE STATE OF VERMONT ENVIRONMENTAL PROTECTION RULES. UNLESS OTHERWISE NOTED, ALL MATERIALS, ITEMS AND INSTALLATION PROCEDURES SHALL CONFORM TO THE LATEST EDITION OF THE VERMONT AGENCY OF TRANSPORTATION (AOT) STANDARD SPECIFICATIONS FOR CONSTRUCTION.
- 10) THE TOLERANCE FOR ALL FINISHED GRADES SHALL BE 0.1 FEET.
- 11) THE CONTRACTOR SHALL PROVIDE THE OWNER WITH AS-BUILT DRAWINGS WITHIN 10 DAYS FOLLOWING THE COMPLETION OF THE PROJECT.
- 12) ELEVATIONS AND COORDINATES SHOWN ARE BASED UPON AN ASSUMED DATUM. ORIENTATION IS BASED UPON THE PLAT REFERENCED IN NOTE 13 BELOW.

13) PROPERTY LINE INFORMATION BASED UPON A PLAT ENTITLED "BARRE GRANITE ASSOCIATION – VT ROUTE 14 – EAST MONTPELIER, VERMONT – PROPERTY SUBDIVISION", DATED MARCH, 1983, PREPARED BY WAYNE D. LAWRENCE, P.E. AND RECORDED MAP BOOK 2/104 (SLIDE 26) OF THE EAST MONTPELIER LAND RECORDS. MONUMENTATION FOUND WAS CONSISTENT WITH THE RECORDED PLAT. THE PROPERTY LINES, EASEMENTS, AND OTHER REAL PROPERTY DESCRIPTIONS PROVIDED IN THIS PERMIT APPLICATION ARE FOR PERMITTING PURPOSES ONLY. THEY DO NOT DEFINE LEGAL RIGHTS OR MEET LEGAL REQUIREMENTS FOR A LAND SURVEY AS DESCRIBED IN 26 V.S.A. & 2502(4), AND SHALL NOT BE USED IN LIEU OF A SURVEY AS THE BASIS OF ANY LAND TRANSFER OR ESTABLISHMENT OF ANY PROPERTY RIGHTS. THIS IS NOT A BOUNDARY SURVEY AND IS NOT INTENDED TO BE USED AS ONE.

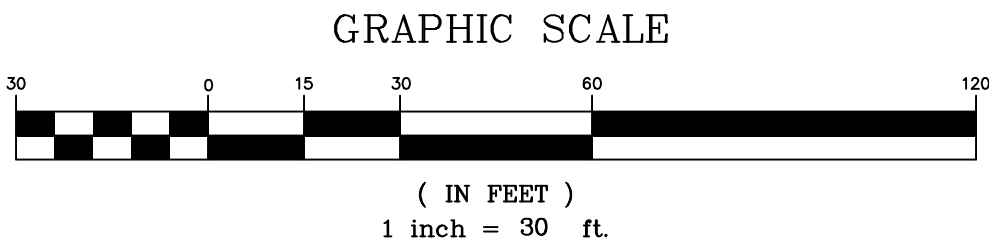
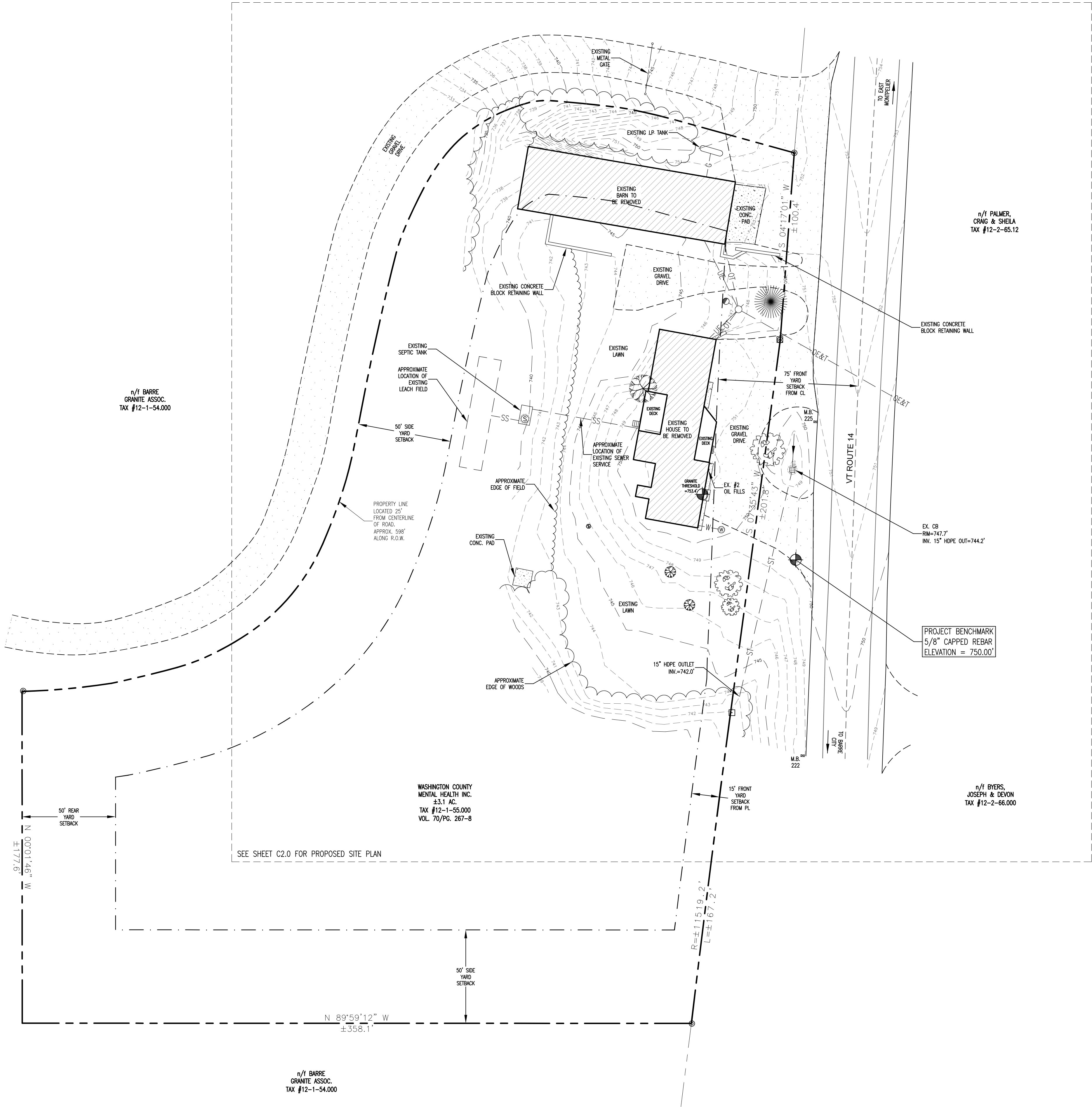

COPYRIGHT © 2018

OWNER:

Washington County
Mental Health Inc.
P.O. Box 647
Montpelier, VT 05601-0647

PROJECT:

Proposed
Maintenance
Facility
225 VT RTE 14S
East Montpelier, VT 05651

SHEET TITLE:

Existing
Conditions
Site Plan

EAST MONTPELIER

PROJECT
LOCATION

LOCATION MAP 1" = ±2,000'

- ☐ PRELIMINARY
☒ FOR PERMITTING
☐ NOT FOR CONSTRUCTION
☐ FOR CONSTRUCTION

PROJECT NO.: 18011

DATE: JUNE 22, 2018

SCALE: 1" = 30'

REV. NO.	DESCRIPTION	DATE
1	REV'S PER AOT COMMENTS	7/23/18
2		
3		
4		
5		
6		
7		
8		
9		
10		

SHEET NUMBER:

C1.0

LEGEND

- 985 --- EXISTING CONTOUR
— 985 — PROPOSED CONTOUR
- - - - - APPROXIMATE PROPERTY LINE
- - - - - APPROXIMATE SETBACK LINE
- - - - - APPROXIMATE EASEMENT LINE
— SS — APPROXIMATE GRAVITY SEWER LINE
— FM — APPROXIMATE SEWER FORCE MAIN
— ST — APPROXIMATE STORM DRAINAGE LINE
— W — APPROXIMATE WATER LINE
— OE — APPROXIMATE OVERHEAD ELECTRICAL LINE
— UE — APPROXIMATE UNDERGROUND ELECTRICAL LINE
— G — APPROXIMATE GAS LINE
— x — x — FENCE
— — — DRAINAGE SWALE/DITCH
~ ~ ~ APPROXIMATE EDGE OF WOODS
DECIDUOUS TREE
CONIFEROUS TREE
SHRUB/PLANTING
SEWER MANHOLE
DRAINAGE MANHOLE
DRAINAGE CATCH BASIN
DRILLED WELL
POWER POLE
GUY WIRE
LIGHT POLE
SIGN POST
IRON PIPE/ROD FOUND/SET
CONCRETE MONUMENT FOUND/SET
PROJECT BENCHMARK

ZONING REQUIREMENTS

ZONING DISTRICT — RURAL RESIDENTIAL—AGRICULTURAL DISTRICT (ZONE D)
ZONING OVERLAYS — NONE
PROPOSED USE — MAINTENANCE FACILITY (CONDITIONAL USE)

DIMENSIONAL REQUIREMENTS —

	REQUIRED	EXISTING	PROPOSED
MINIMUM LOT SIZE (AC) —	3.0	±3.1	±3.1
MINIMUM FRONTAGE (FT) —	250	±470	±470
MINIMUM FRONT SETBACK (FT) —	75/15	±77	97
MINIMUM SIDE SETBACK (FT) —	50	107	92
MINIMUM REAR SETBACK (FT) —	50	346	274
MAXIMUM HEIGHT (FT) —	35	<35	<35

NOTES —

- FRONT SETBACK REQUIREMENT IS 75 FT FROM CENTERLINE OF STATE ROAD OR 15 FT FROM EDGE OF ROW. FOR THIS PROJECT LOCATION, THE 75 FT REQUIREMENT IS MORE STRINGENT AND SHALL BE MET.
- THE EXISTING BARN REPRESENTS AN EXISTING, NONCONFORMING, GRANDFATHERED STRUCTURE TO BE REMOVED.

DESIGN FLOWS

EXISTING WATER DEMAND AND SEWER FLOWS —

EXISTING 6 BEDROOM HOUSE —
(3 BEDROOMS @ 140 GPD) + (3 BEDROOMS @ 70 GPD) = 630 GPD

PROPOSED WATER DEMAND AND SEWER FLOWS —

PROPOSED OFFICE AND MAINTENANCE BUILDING —
24 EMPLOYEES @ 15 GPD/EMPLOYEE = 360 GPD
LOW FLOW FIXTURE CREDIT (10%) = -36 GPD
TOTAL PROPOSED WATER DEMAND AND SEWER FLOW = 324 GPD

NOTE: EXCESS GRANDFATHERED DESIGN FLOWS OF 306 GPD (630-324) TO BE PLACED IN RESERVE FOR POTENTIAL FUTURE USE.

PARKING SUMMARY

PARKING SPACES REQUIRED —

1 SPACE/EMPLOYEE @ 24 EMPLOYEES = 24 SPACES

PARKING SPACES PROVIDED —

STANDARD SPACES = 28 SPACES
HANDICAP SPACES = 2 SPACES
TOTAL SPACES PROVIDED = 30 SPACES

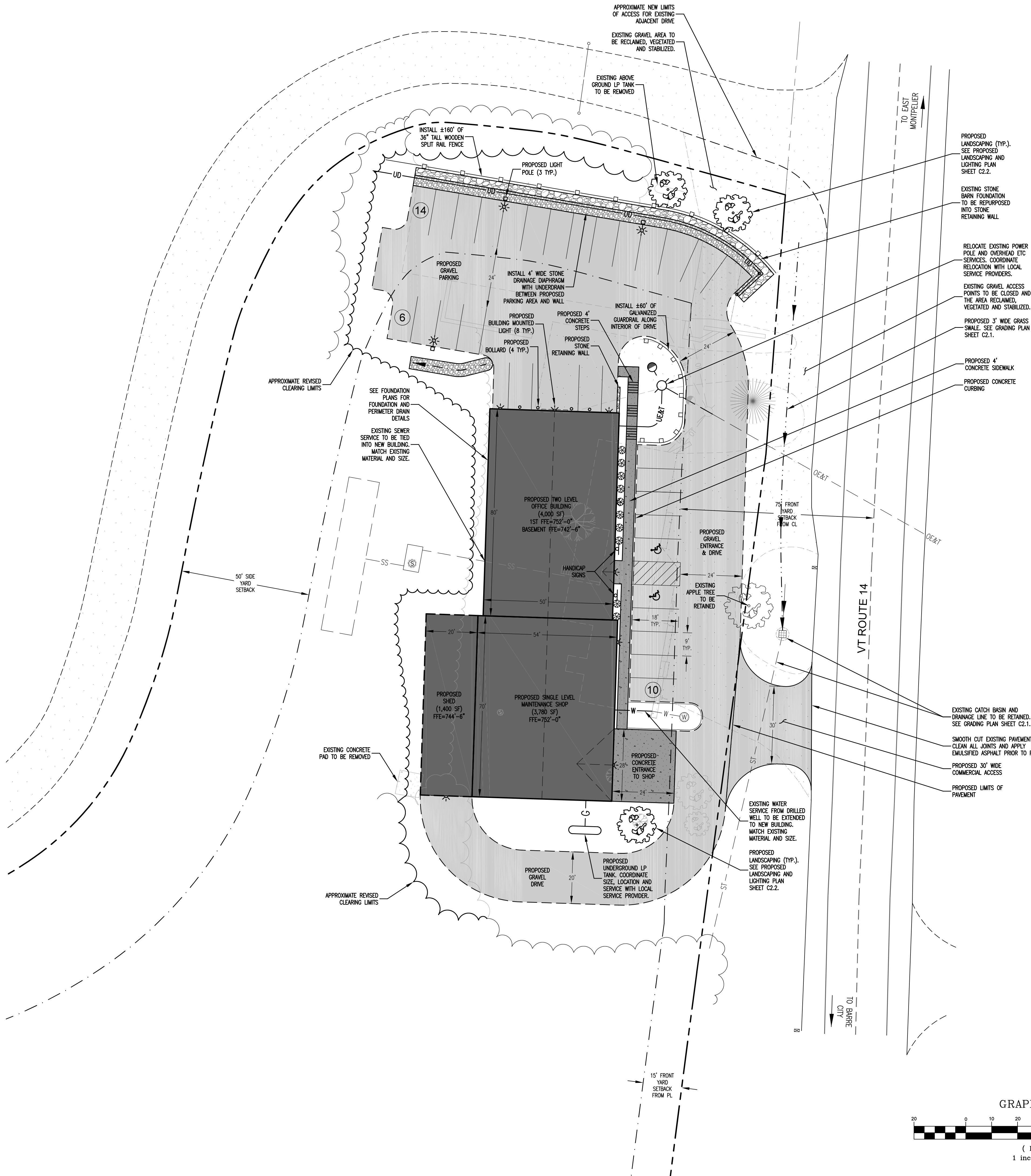

OWNER:

Washington County
Mental Health Inc.
P.O. Box 647
Montpelier, VT 05601-0647

PROJECT:

Proposed
Maintenance
Facility
225 VT RTE 14S
East Montpelier, VT 05651

SHEET TITLE:

Proposed
Conditions
Site Plan

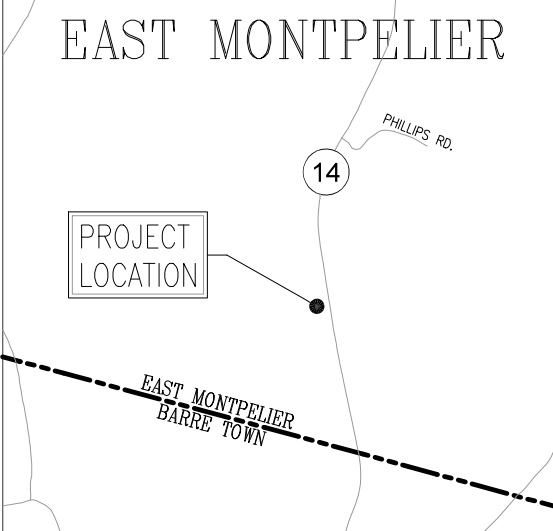

LOCATION MAP 1" = ±2,000'

- ☐ PRELIMINARY
☒ FOR PERMITTING
☐ NOT FOR CONSTRUCTION
☐ FOR CONSTRUCTION

PROJECT NO.: 18011		
DATE: JUNE 22, 2018		
SCALE: 1" = 20'		
REV. NO.	DESCRIPTION	DATE
1	REV'S PER AOT COMMENTS	7/23/18
2		
3		
4		
5		
6		
7		
8		
9		
10		

SHEET NUMBER:

C2.0

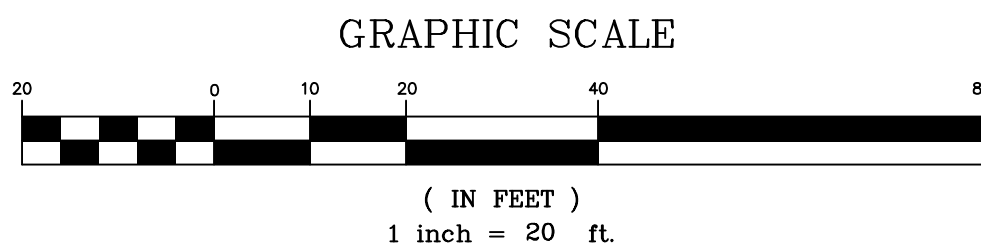

LEGEND

- 985 --- EXISTING CONTOUR
— 985 — PROPOSED CONTOUR
- - - - - APPROXIMATE PROPERTY LINE
- - - - - APPROXIMATE SETBACK LINE
- - - - - APPROXIMATE EASEMENT LINE
— SS — APPROXIMATE GRAVITY SEWER LINE
— FM — APPROXIMATE SEWER FORCE MAIN
— ST — APPROXIMATE STORM DRAINAGE LINE
— W — APPROXIMATE WATER LINE
— OE — APPROXIMATE OVERHEAD ELECTRICAL LINE
— UE — APPROXIMATE UNDERGROUND ELECTRICAL LINE
— G — APPROXIMATE GAS LINE
— x — x — FENCE
— —> — DRAINAGE SWALE/DITCH
~ ~ ~ ~ ~ APPROXIMATE EDGE OF WOODS
DECIDUOUS TREE
CONIFEROUS TREE
SHRUB/PLANTING
SEWER MANHOLE
DRAINAGE MANHOLE
DRAINAGE CATCH BASIN
DRILLED WELL
POWER POLE
GUY WIRE
LIGHT POLE
SIGN POST
IRON PIPE/ROD FOUND/SET
CONCRETE MONUMENT FOUND/SET
PROJECT BENCHMARK

SEE NOTE 12, SHEET C10

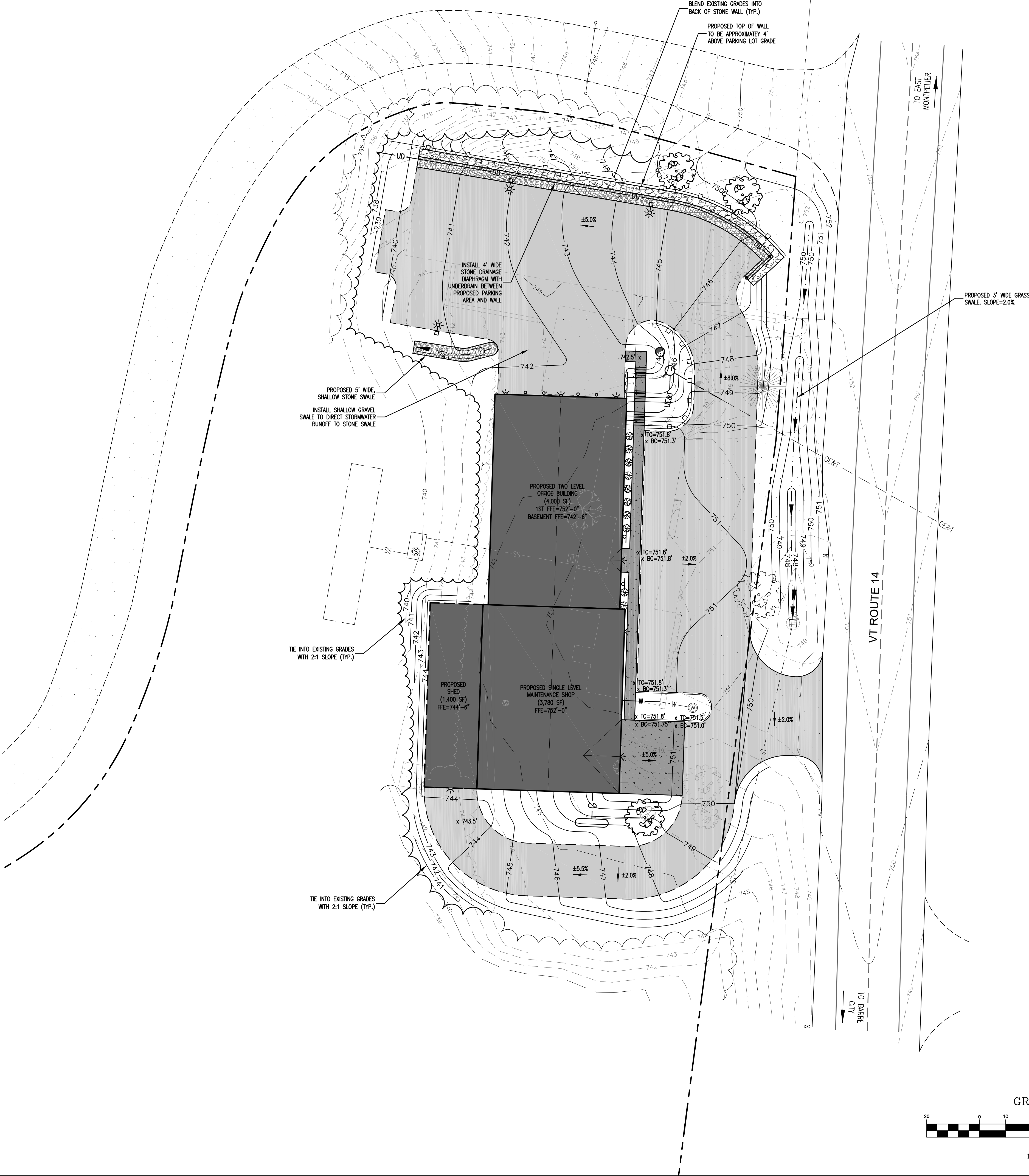

COPYRIGHT © 2018

OWNER:

Washington County
Mental Health Inc.
P.O. Box 647
Montpelier, VT 05601-0647

PROJECT:

Proposed
Maintenance
Facility
225 VT RTE 14S
East Montpelier, VT 05651

SHEET TITLE:

Proposed
Grading
Site Plan

EAST MONTEPELIER

PROJECT
LOCATION

LOCATION MAP 1" = ±2,000'

- ☐ PRELIMINARY
☒ FOR PERMITTING
☐ NOT FOR CONSTRUCTION
☐ FOR CONSTRUCTION

PROJECT NO.: 18011

DATE: JUNE 22, 2018

SCALE: 1" = 20'

REV. NO.	DESCRIPTION	DATE
1	REV'S PER ADT COMMENTS	7/23/18
2		
3		
4		
5		
6		
7		
8		
9		
10		

SHEET NUMBER:

C2.1

LEGEND

---	985	---	EXISTING CONTOUR
---	985	---	PROPOSED CONTOUR
---	---	---	APPROXIMATE PROPERTY LINE
---	---	---	APPROXIMATE SETBACK LINE
---	---	---	APPROXIMATE EASEMENT LINE
---	SS	---	APPROXIMATE GRAVITY SEWER LINE
---	FM	---	APPROXIMATE SEWER FORCE MAIN
---	ST	---	APPROXIMATE STORM DRAINAGE LINE
---	W	---	APPROXIMATE WATER LINE
---	OE	---	APPROXIMATE OVERHEAD ELECTRICAL LINE
---	UE	---	APPROXIMATE UNDERGROUND ELECTRICAL LINE
---	G	---	APPROXIMATE GAS LINE
---	x	x	FENCE
---	---	---	DRAINAGE SWALE/DITCH
---	---	---	APPROXIMATE EDGE OF WOODS
---	---	---	DECIDUOUS TREE
---	---	---	CONIFEROUS TREE
---	---	---	SHRUB/PLANTING
---	S	---	SEWER MANHOLE
---	D	---	DRAINAGE MANHOLE
---	---	---	DRAINAGE CATCH BASIN
---	---	---	DRILLED WELL
---	---	---	POWER POLE
---	---	---	GUY WIRE
---	---	---	LIGHT POLE
---	---	---	SIGN POST
---	---	---	IRON PIPE/ROD FOUND/SET
---	---	---	CONCRETE MONUMENT FOUND/SET
---	---	---	PROJECT BENCHMARK

SEE NOTE 12, SHEET C1.0

PROPOSED LIGHTING SCHEDULE

SYMBOL	QUANTITY	NAME	DETAILS	MOUNTING TYPE
CL	3	HUBBELL CIMARRON	BRONZE, BACK LIGHT CONTROL & MOTION SENSOR (CL1-A-60L-E-4K-4-105-DB-BC/SCO)	POLE @ 20 FT.
SG	8	HUBBELL SLING	BRONZE, MOTION SENSOR (SG1-20-4K7-FT-120-DB-SCO)	BUILDING @ 10 FT.

PROPOSED LANDSCAPING SCHEDULE

CODE	SCIENTIFIC NAME	COMMON NAME	QUANTITY	SIZE
TREES:				
AR	ACER RUBRUM 'AUTUMN BLAZE'	RED MAPLE	3	2.5"-3" CAL.
SHRUBS:				
FM	FORSYTHIA x INTERMEDIA 'MINDOR'	BORDER FORSYTHIA	10	36" HT.

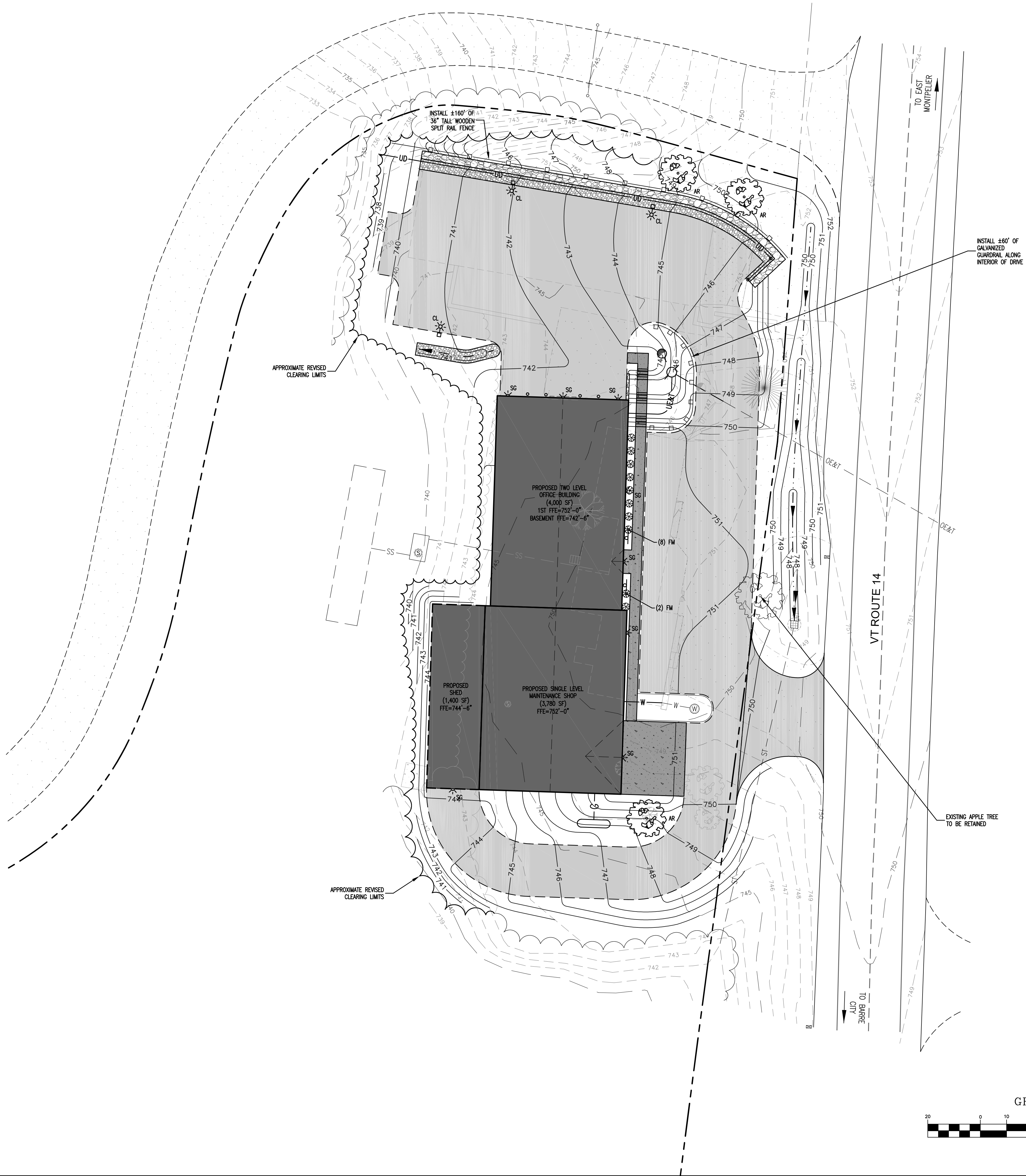

OWNER:

Washington County
Mental Health Inc.
P.O. Box 647
Montpelier, VT 05601-0647

PROJECT:

Proposed
Maintenance
Facility
225 VT RTE 14S
East Montpelier, VT 05651

SHEET TITLE:

Proposed
Landscaping
& Lighting
Site Plan

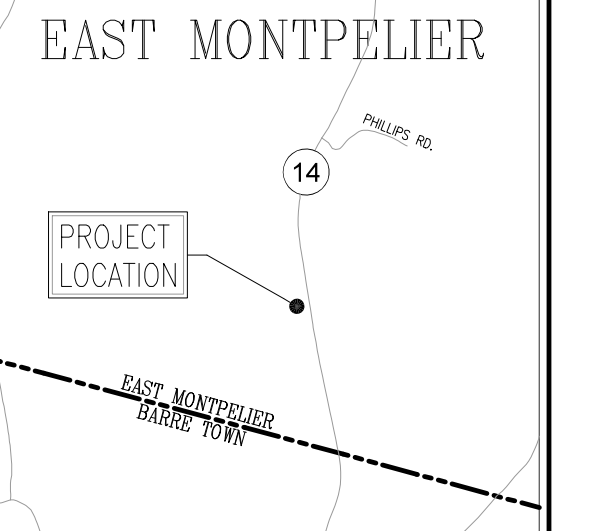

LOCATION MAP 1" = ±2,000'

- ☐ PRELIMINARY
☒ FOR PERMITTING
☐ NOT FOR CONSTRUCTION
☐ FOR CONSTRUCTION

PROJECT NO.: 18011		
DATE: JUNE 22, 2018		
SCALE: 1" = 20'		
REV. NO.	DESCRIPTION	DATE
1	REV'S PER AOT COMMENTS	7/23/18
2		
3		
4		
5		
6		
7		
8		
9		
10		

SHEET NUMBER:

C2.2

LEGEND

- 985 --- EXISTING CONTOUR
— 985 — PROPOSED CONTOUR
- - - - - APPROXIMATE PROPERTY LINE
- - - - - APPROXIMATE SETBACK LINE
- - - - - APPROXIMATE EASEMENT LINE
— SS — APPROXIMATE GRAVITY SEWER LINE
— FM — APPROXIMATE SEWER FORCE MAIN
— ST — APPROXIMATE STORM DRAINAGE LINE
— W — APPROXIMATE WATER LINE
— OE — APPROXIMATE OVERHEAD ELECTRICAL LINE
— UE — APPROXIMATE UNDERGROUND ELECTRICAL LINE
— G — APPROXIMATE GAS LINE
— x — x — FENCE
— — — — — DRAINAGE SWALE/DITCH
~ ~ ~ ~ ~ APPROXIMATE EDGE OF WOODS
☼ DECIDUOUS TREE
☼ CONIFEROUS TREE
☼ SHRUB/PLANTING
Ⓢ SEWER MANHOLE
Ⓢ DRAINAGE MANHOLE
Ⓢ DRAINAGE CATCH BASIN
Ⓢ DRILLED WELL
Ⓢ POWER POLE
Ⓢ GUY WIRE
Ⓢ LIGHT POLE
Ⓢ SIGN POST
Ⓢ IRON PIPE/ROD FOUND/SET
Ⓢ CONCRETE MONUMENT FOUND/SET
Ⓢ PROJECT BENCHMARK

SEE NOTE 12, SHEET C10

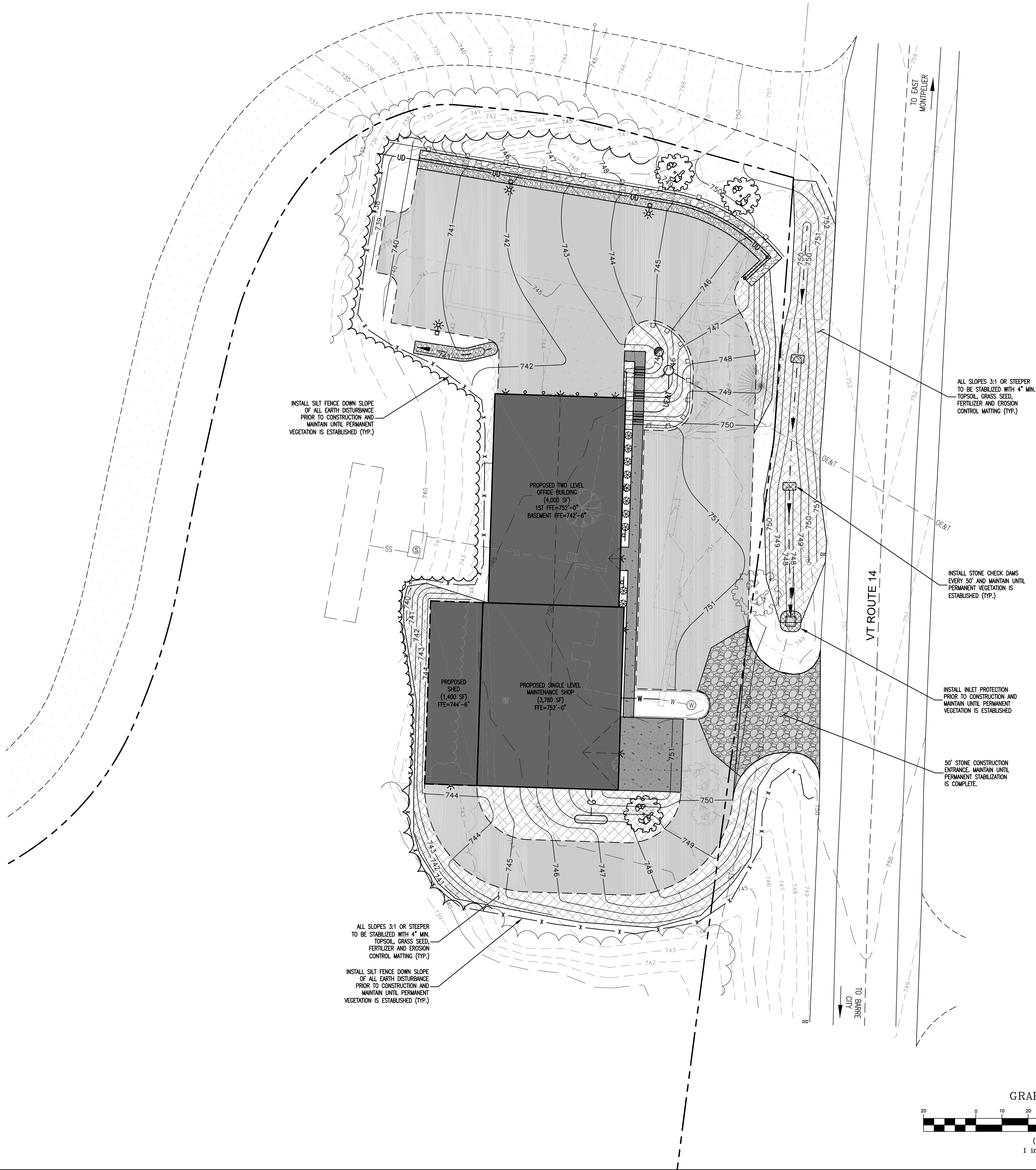

EROSION PREVENTION AND SEDIMENT CONTROL NOTES

1. IN ADDITION TO THESE PLANS AND DETAILS, ALL EROSION PREVENTION AND SEDIMENT CONTROL MEASURES SHALL BE INSTALLED AND MAINTAINED IN ACCORDANCE WITH THE VERMONT STANDARDS AND SPECIFICATIONS FOR EROSION PREVENTION AND SEDIMENT CONTROL FOR LOW RISK PROJECTS.
2. THE DISCHARGE OF SEDIMENT LADEN WATER FROM THE PROJECT SITE IS PROHIBITED. ALL DISCHARGED WATER FROM DEWATERING OPERATIONS SHALL DISCHARGE INTO A TEMPORARY SEDIMENT CONTROL TRAP OR SEDIMENTATION BASIN. THE CONTRACTOR SHALL BE RESPONSIBLE FOR INSPECTING AND MAINTAINING ALL EROSION CONTROL MEASURES UNTIL THE PROJECT IS COMPLETE.
3. THE CONTRACTOR SHALL LIMIT SOIL DISTURBANCE AND SEEDING APPLICATION DATES TO BETWEEN APRIL 15TH AND OCTOBER 15TH. IF SOIL DISTURBANCE OCCURS LATER THAN OCTOBER 15TH OR PRIOR TO APRIL 15TH, WINTER EROSION CONTROL MEASURES WILL BE NECESSARY. THE CONTRACTOR SHALL CONSULT WITH THE ENGINEER FOR ADDITIONAL SPECIFIC WINTER EROSION CONTROL MEASURES.
4. ALL STOCKPILE MATERIAL (TOPSOIL, BORROW, ETC.) SHALL HAVE SILT FENCE CONSTRUCTED AROUND THE PERIMETER. SEED AND MULCH STOCKPILED MATERIAL AS SOON AS POSSIBLE TO PREVENT SOIL EROSION AND SEDIMENTATION OFF SITE. LOCATE STOCKPILES ON THE UPHILL SIDE OF THE DISTURBED AREAS, IF POSSIBLE. DURING WINDY CONDITIONS, STOCKPILED MATERIAL SHALL BE COVERED OR WATERED APPROPRIATELY TO PREVENT WIND EROSION.
5. SLOPES GREATER THAN 3H:1V SHALL HAVE EROSION CONTROL MATTING INSTALLED TO STABILIZE THE SLOPE AND REDUCE THE POTENTIAL FOR EROSION. INSTALL MATTING OVER MULCHED SLOPES SO THAT ALL PARTS ARE IN CONTACT WITH THE SOIL AND MULCH. PIN NETTING WITH WIRE STAPLES 3' O.C. TO ENSURE FULL BONDING WITH SOIL SURFACE.
6. INSTALL STONE CHECK DAMS IN GRASS LINES SWALES AS SHOWN ON PLANS, OR 50' O.C., TO PREVENT SILT FROM WASHING INTO THE DRAINAGE SYSTEM DURING CONSTRUCTION. STONE CHECK DAMS SHALL BE REMOVED WHEN PERMANENT VEGETATION IS ESTABLISHED.
7. AS SOON AS CONSTRUCTION IS COMPLETED IN A GIVEN AREA, IT SHALL BE TOPSOILED, SEEDED, FERTILIZED AND MULCHED.
8. ALL EROSION CONTROL MEASURES SHALL BE INSPECTED WEEKLY, AND AFTER PERIODS OF HEAVY RAIN, AND REPAIRED AND/OR REPLACED AS NEEDED.

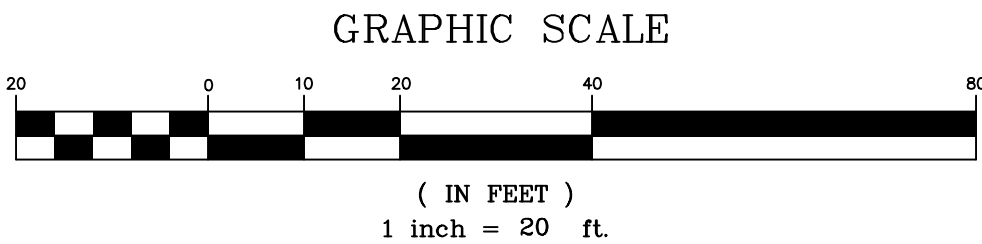

COPYRIGHT © 2018

OWNER:

Washington County
Mental Health Inc.
P.O. Box 647
Montpelier, VT 05601-0647

PROJECT:

Proposed
Maintenance
Facility
225 VT RTE 14S
East Montpelier, VT 05651

SHEET TITLE:

Proposed
Erosion Prevention
& Sediment
Control Site Plan

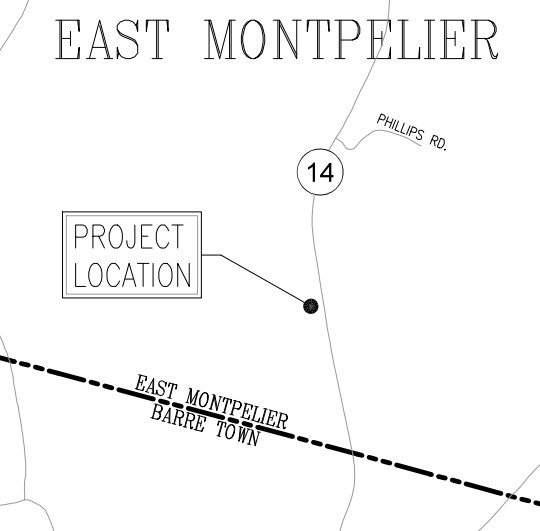

LOCATION MAP 1" = ±2,000'

- ☐ PRELIMINARY
☒ FOR PERMITTING
☐ NOT FOR CONSTRUCTION
☐ FOR CONSTRUCTION

PROJECT NO.: 18011

DATE: JUNE 22, 2018

SCALE: 1" = 20'

REV. NO.	DESCRIPTION	DATE
1	REV'S PER AOT COMMENTS	7/23/18
2		
3		
4		
5		
6		
7		
8		
9		
10		

SHEET NUMBER:

C2.3

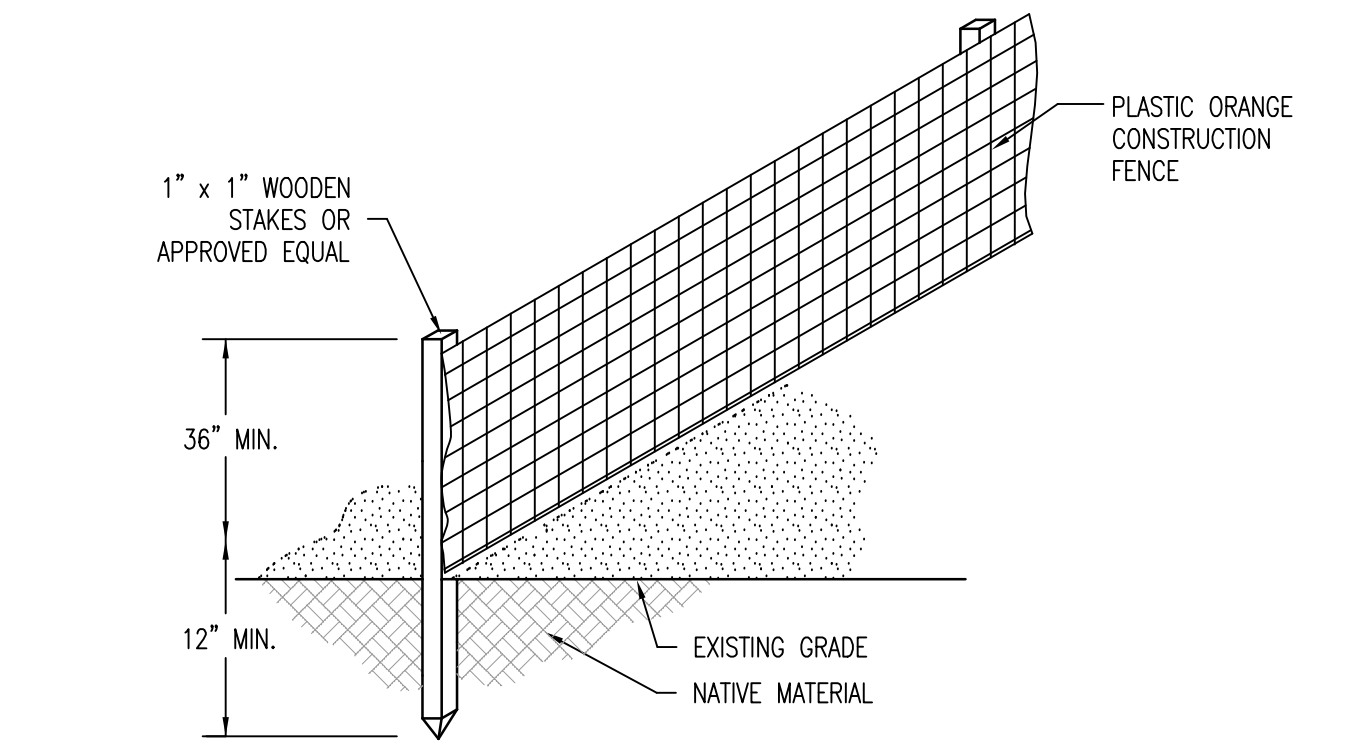

- NOTES:
1. PROJECT DEMARCATION FENCE TO BE INSTALLED IN ACCORDANCE WITH AOT SPEC 653.14.
 2. WOODEN STAKES TO BE INSTALLED A MINIMUM OF 10" O/C.
 3. PROJECT DEMARCATION FENCE TO BE INSTALLED PRIOR TO ANY CONSTRUCTION AND MAINTAINED THROUGHOUT THE CONSTRUCTION PROCESS.

PROJECT DEMARCATION FENCE DETAIL

1
C3.0

N.T.S.

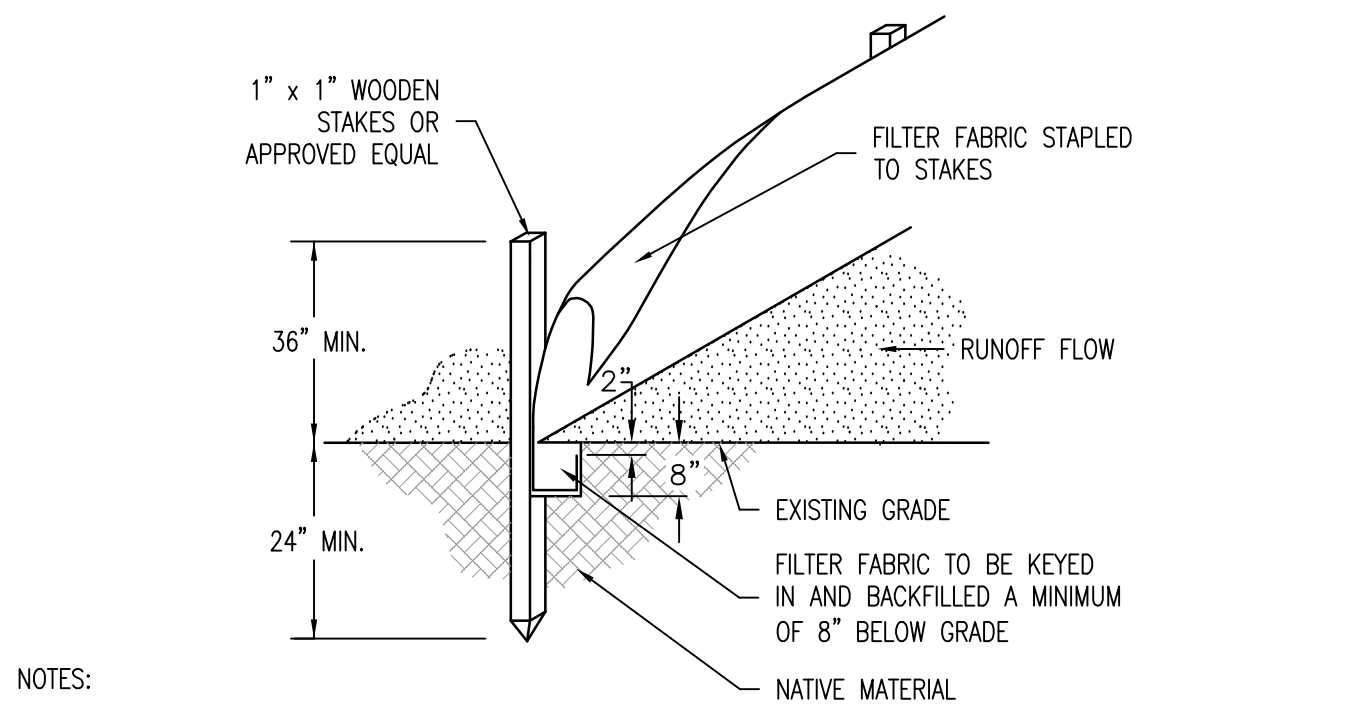

- NOTES:
1. SILT FENCE TO BE INSTALLED IN ACCORDANCE WITH AOT SPEC 649.04(6) AND USING MATERIAL MEETING AOT SPEC 720.04 FOR SILT FENCE.
 2. WOODEN STAKES TO BE INSTALLED A MINIMUM OF 6' O/C.
 3. INSTALL SILT FENCES AT TOES OF ALL UNPROTECTED SLOPES AND AS PARALLEL TO CONTOURS AS POSSIBLE. THIS INCLUDES ALL FILLED OR UNPROTECTED SLOPES CREATED DURING CONSTRUCTION, NOT NECESSARILY REFLECTED ON THE FINAL PLANS. CURVE THE ENDS OF THE FENCE UP INTO THE SLOPE. WHEN SILT FENCE IS INSTALLED ON MINOR CROSS SLOPES, "J" HOOKS SHALL BE INSTALLED EVERY 50' MINIMUM TO MINIMIZE SEDIMENT LOAD AT BOTTOM OF SLOPE. WHEN TWO SECTIONS OF FABRIC ADJOIN EACH OTHER, THEY SHALL BE OVERLAPPED BY 6", FOLDED AND STAPLED.
 4. SILT FENCE TO BE INSTALLED PRIOR TO CONSTRUCTION AND MAINTAINED UNTIL SLOPES ARE STABILIZED AND PERMANENT VEGETATION IS ESTABLISHED. REMOVE SEDIMENT WHEN ACCUMULATED TO HALF THE HEIGHT OF THE FENCE.

SILT FENCE DETAIL

2
C3.0

N.T.S.

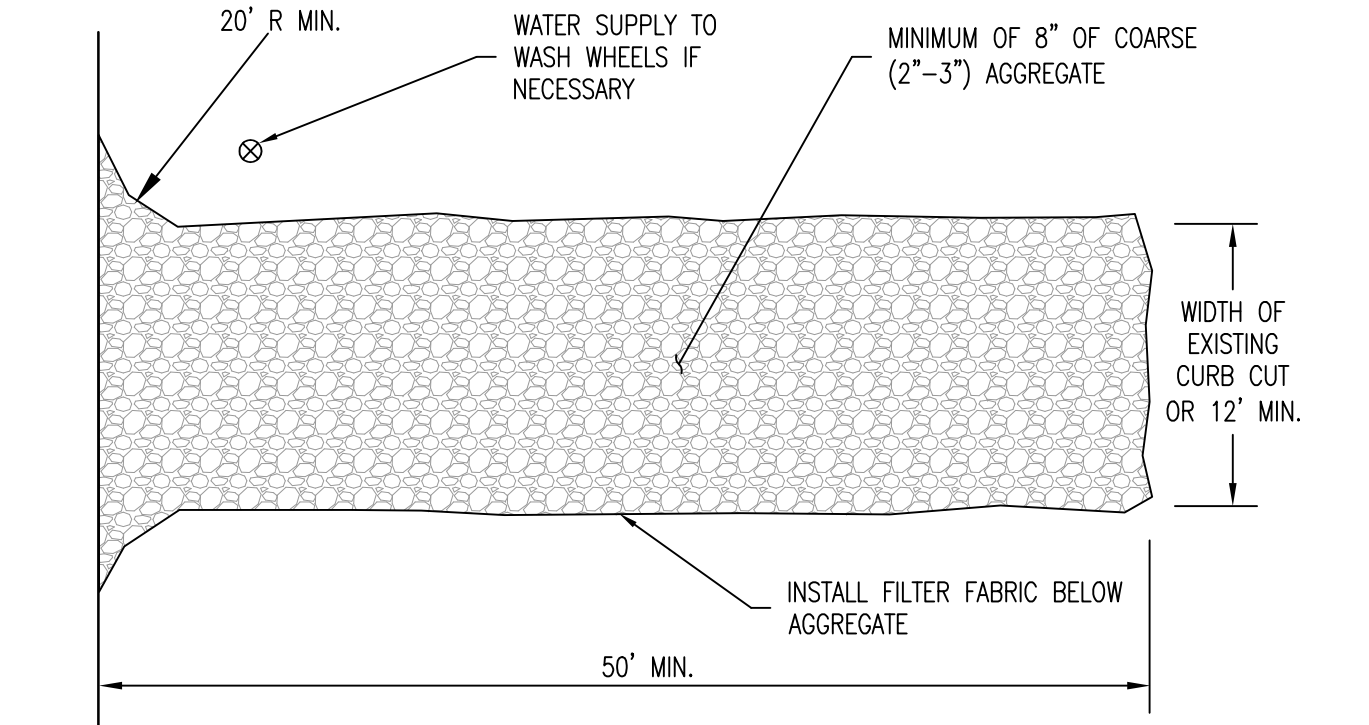

- NOTES:
1. STONE CONSTRUCTION ENTRANCE TO BE INSTALLED IN ACCORDANCE WITH AOT SPEC 653.10 AND USING MATERIAL MEETING AOT SPEC 704.17A. FILTER FABRIC TO MEET AOT SPEC 720.04 FOR GEOTEXTILE FOR ROADBED SEPARATOR.
 2. THE ENTRANCE SHALL BE MAINTAINED IN A CONDITION THAT WILL PREVENT TRACKING OF SEDIMENT ONTO THE PUBLIC ROW. THIS MAY REQUIRE MAINTENANCE AND REPAIR OF ANY MEASURES USED TO TRAP SEDIMENT.
 3. WHEN NECESSARY, WHEELS SHALL BE CLEANED PRIOR TO ENTRANCE ONTO THE PUBLIC ROW.
 4. WHEN WASHING IS REQUIRED, IT SHALL BE DONE ON AN AREA STABILIZED WITH STONE AGGREGATE THAT DRAINS INTO AN APPROVED SEDIMENT TRAP.

CONSTRUCTION ENTRANCE DETAIL

3
C3.0

N.T.S.

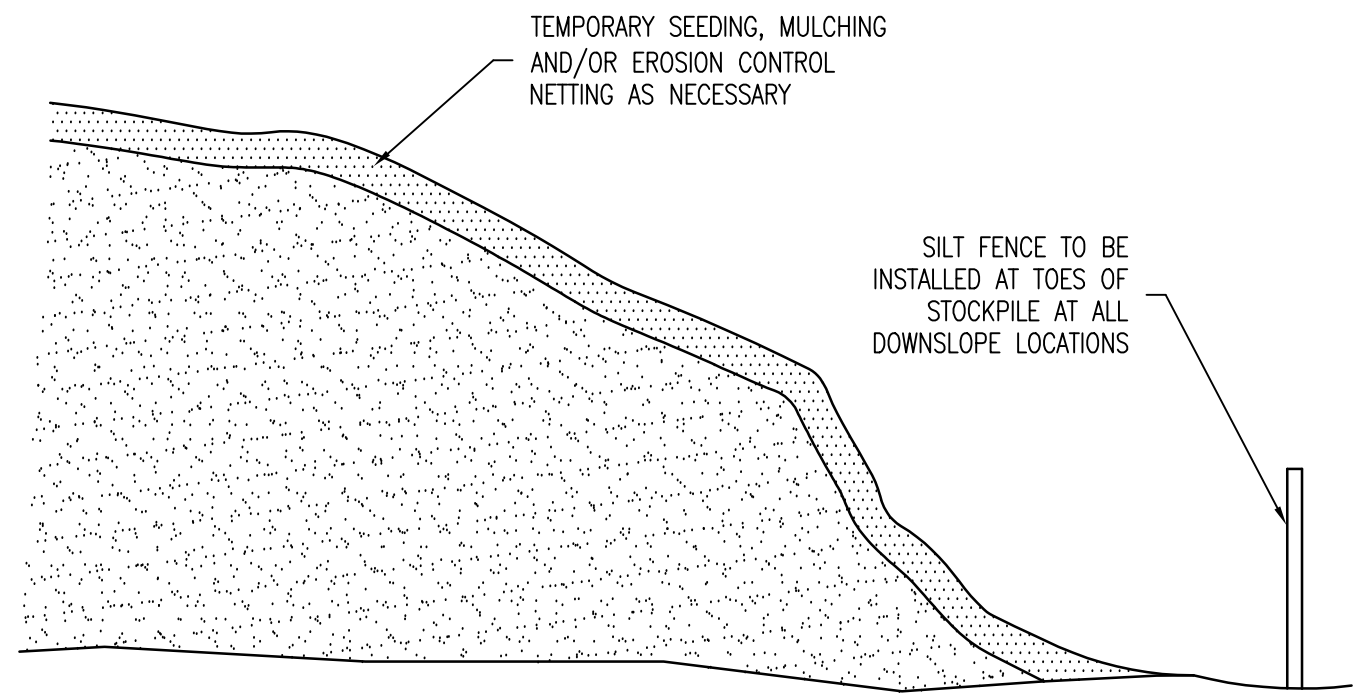

- NOTES:
1. THE STOCKPILE, OR PORTIONS THEREOF, THAT WILL NOT BE USED OR DISTURBED WITHIN 14 DAYS SHALL BE TEMPORARILY STABILIZED WITH MULCH. THE STOCKPILE, OF PORTIONS THEREOF, THAT WILL NOT BE USED OR DISTURBED WITHIN 3 MONTHS SHALL BE STABILIZED WITH GRASS SEED AND MULCH OR EROSION CONTROL NETTING AS NECESSARY TO MINIMIZE THE POTENTIAL FOR EROSION.
 2. SILT FENCE TO BE INSTALLED IN ACCORDANCE WITH AOT SPEC 649.04(6) AND USING MATERIAL MEETING AOT SPEC 720.04 FOR SILT FENCE.

TOPSOIL STOCKPILE DETAIL

4
C3.0

N.T.S.

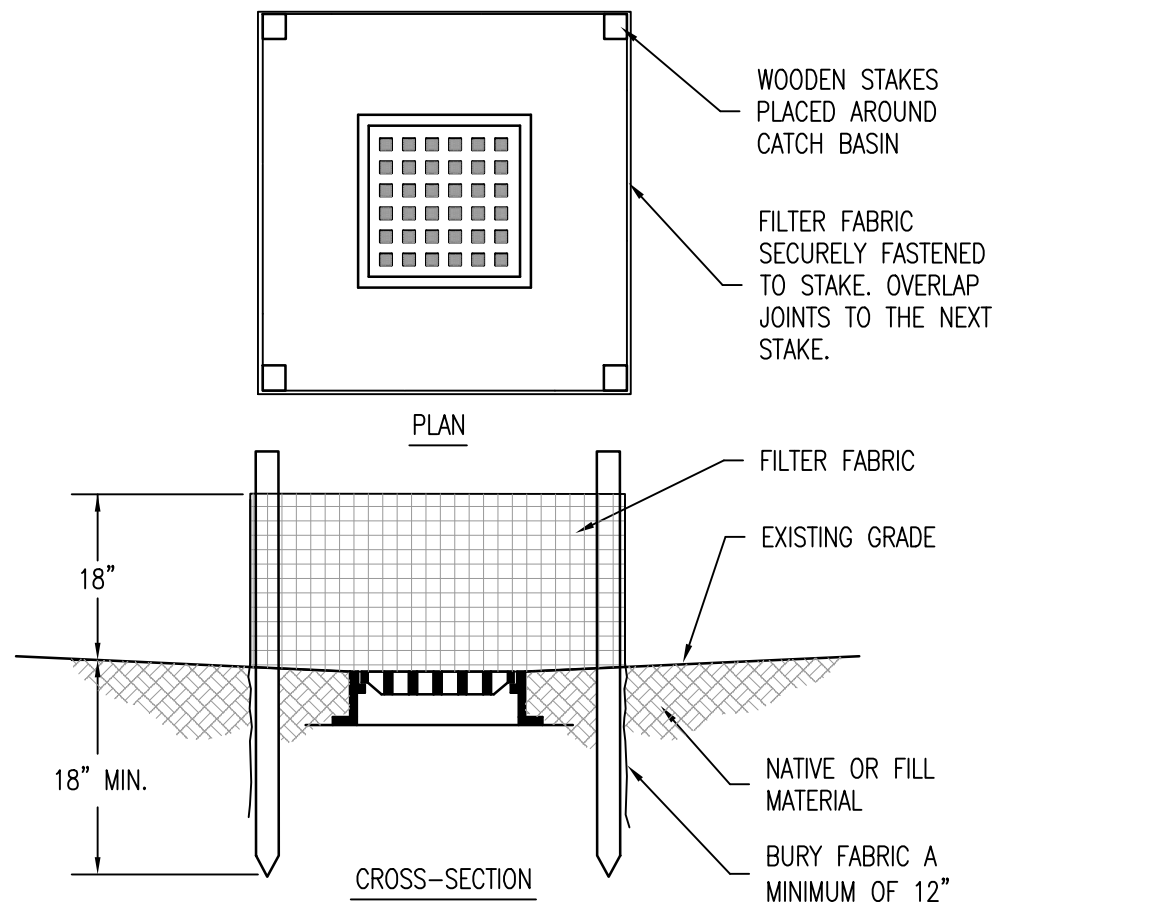

- NOTES:
1. INLET PROTECTION TO BE CONSTRUCTED IN ACCORDANCE WITH AOT SPEC 653.11a. FILTER FABRIC FOR INLET PROTECTION TO MEET AOT SPEC 720.04 FOR SILT FENCE.
 2. INLET PROTECTION TO BE INSTALLED PRIOR TO CONSTRUCTION, OR UPON CONSTRUCTION OF NEW CATCH BASINS, AND MAINTAINED UNTIL PERMANENT VEGETATION IS ESTABLISHED.

CATCH BASIN INLET PROTECTION DETAIL

5
C3.0

N.T.S.

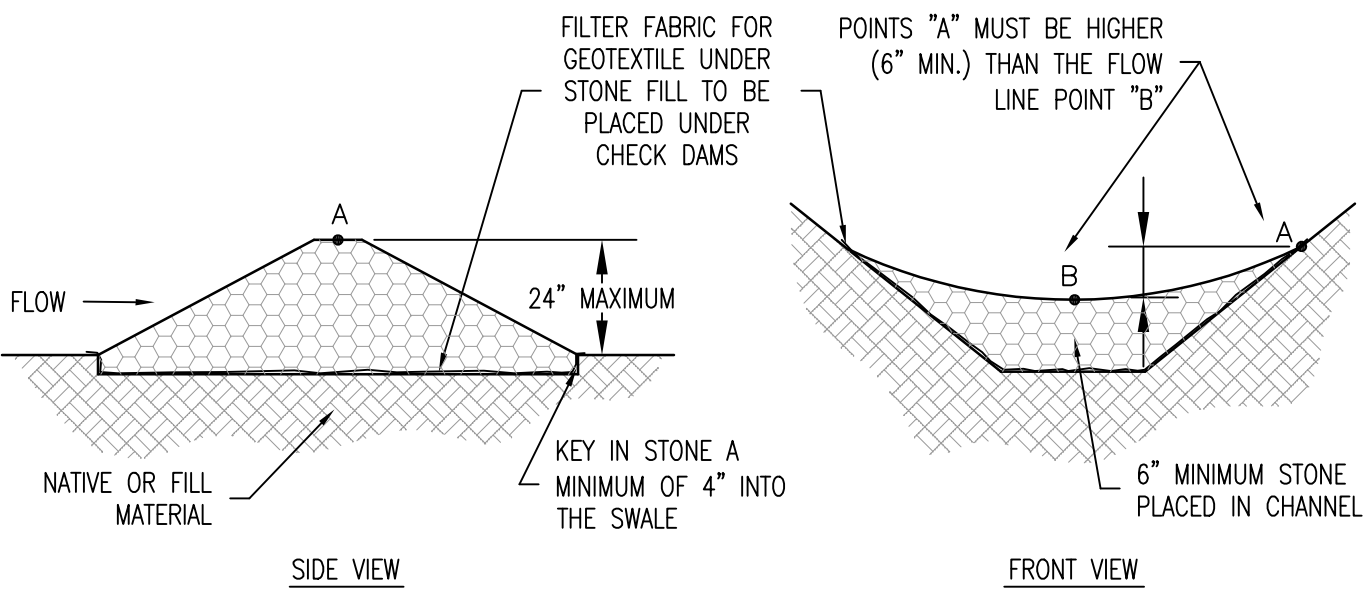

- NOTES:
1. STONE CHECK DAMS TO BE CONSTRUCTED IN ACCORDANCE WITH AOT SPEC 653.06a AND USING MATERIAL MEETING AOT SPEC 704.17. FILTER FABRIC FOR CHECK DAMS TO MEET AOT SPEC 720.04 FOR GEOTEXTILES UNDER STONE FILL.
 2. STONE CHECK DAMS TO BE INSTALLED PRIOR TO CONSTRUCTION, OR UPON CONSTRUCTION OF NEW SWALES, AND MAINTAINED UNTIL PERMANENT VEGETATION IS ESTABLISHED.

STONE CHECK DAM DETAIL

6
C3.0

N.T.S.

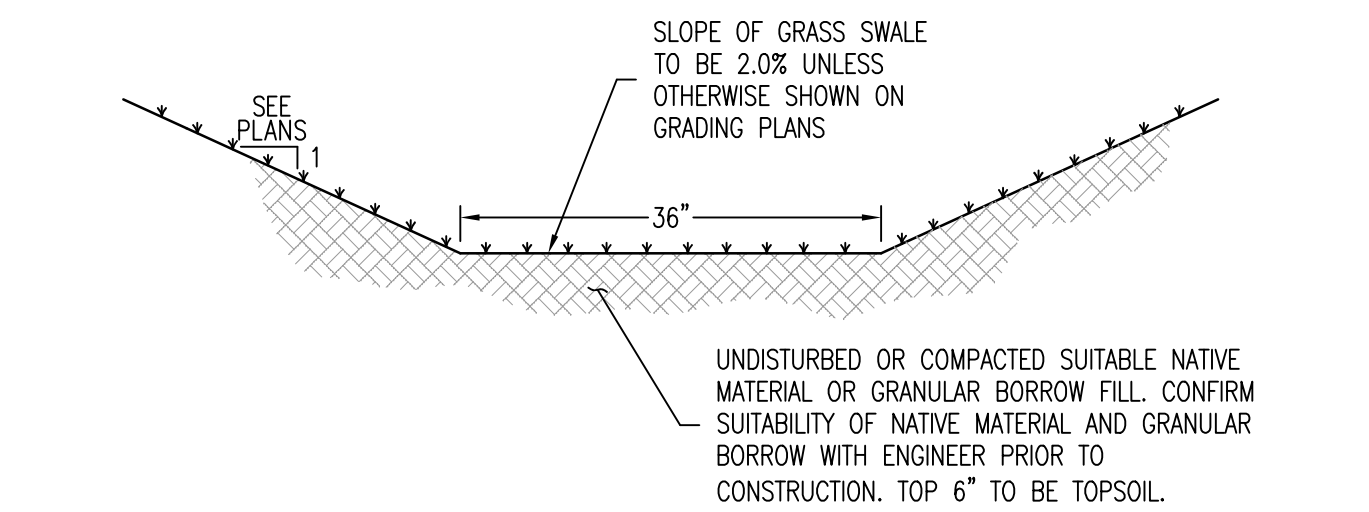

- NOTES:
1. GRANULAR BORROW FILL TO MEET AOT SPEC 703.04.
 2. GRASS SWALE TO BE USED PRIMARILY WHERE SLOPE IS LESS THAN 5% OR AS SHOWN ON GRADING PLANS.

GRASS SWALE DETAIL

7
C3.0

N.T.S.

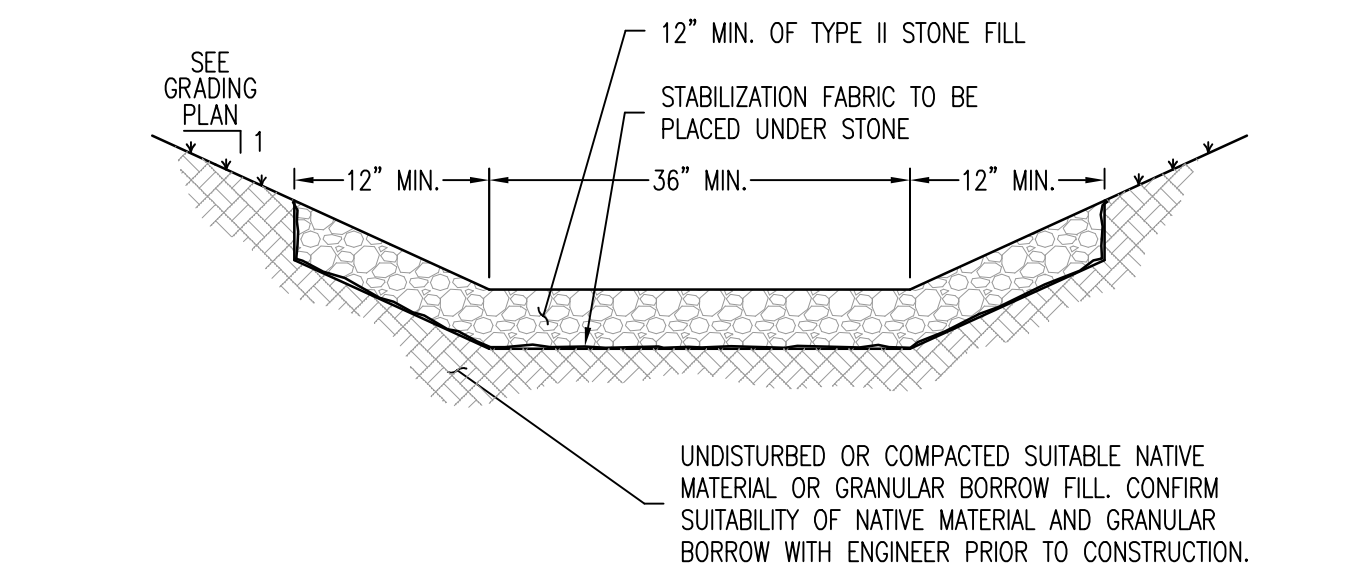

- NOTES:
1. GRANULAR BORROW FILL TO MEET AOT SPEC 703.04.
 2. TYPE II STONE FILL TO MEET AOT SPEC 706.04(b).
 3. STABILIZATION FABRIC TO MEET AOT SPEC 720.04 FOR GEOTEXTILE UNDER STONE FILL.
 4. STONE SWALE TO BE USED PRIMARILY WHERE SLOPE IS EQUAL TO OR EXCEEDS 5% OR AS SHOWN ON GRADING PLANS.

STONE SWALE DETAIL

8
C3.0

N.T.S.

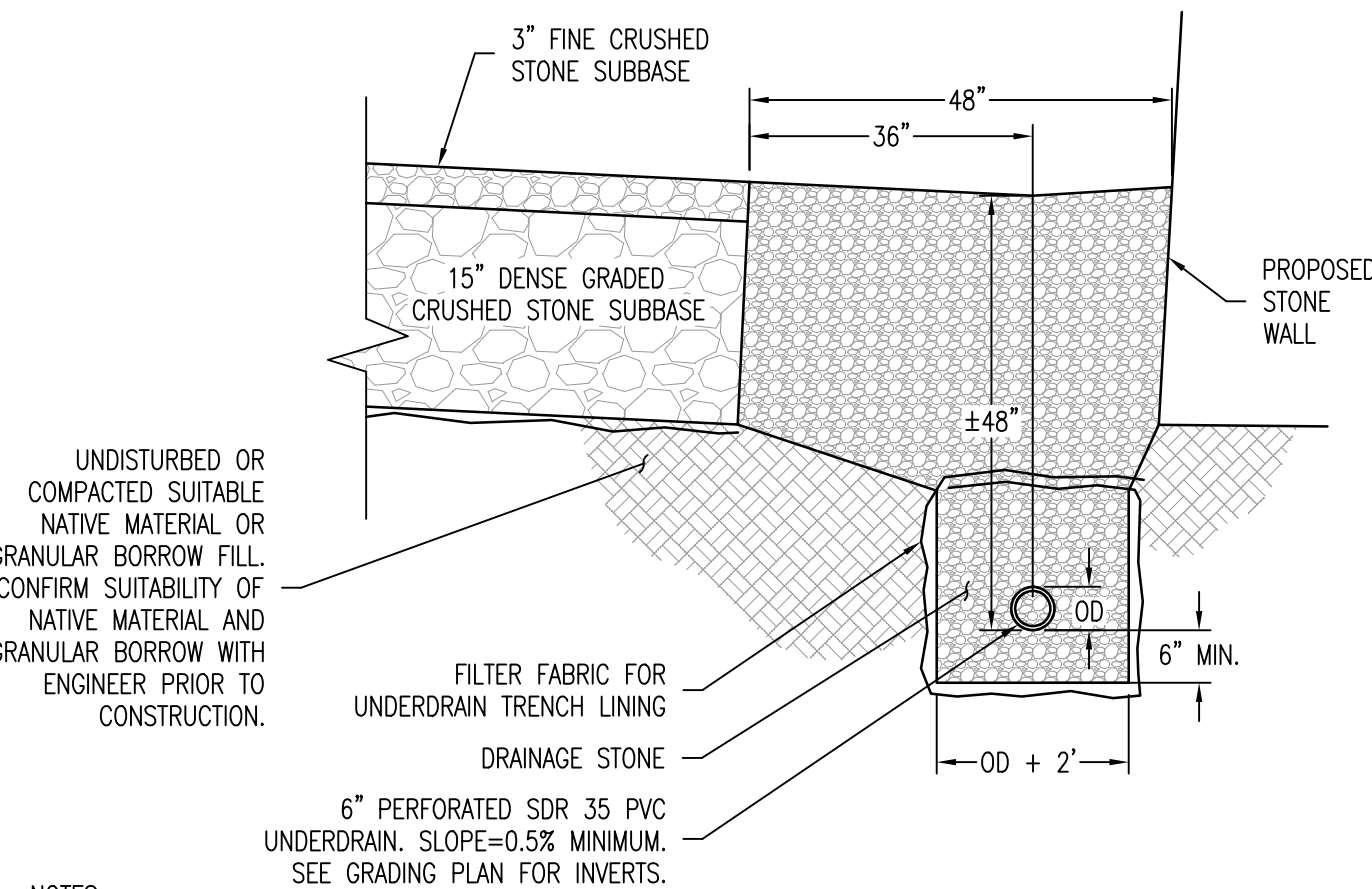

- NOTES:
1. UNDERDRAIN PIPE TO MEET AOT SPEC 710.06 AND BE INSTALLED IN ACCORDANCE WITH AOT SPEC 605.04.
 2. DRAINAGE STONE TO MEET AOT SPEC 704.16.
 3. FILTER FABRIC TO MEET AOT SPEC 720.04 FOR GEOTEXTILE FOR UNDERDRAIN TRENCH LINING.
 4. SAND BORROW FILL TO MEET AOT SPEC 703.03.
 5. COMPACTION OF MATERIALS TO MEET AOT SPEC 301.06.

PARKING LOT UNDERDRAIN DETAIL

9
C3.0

N.T.S.

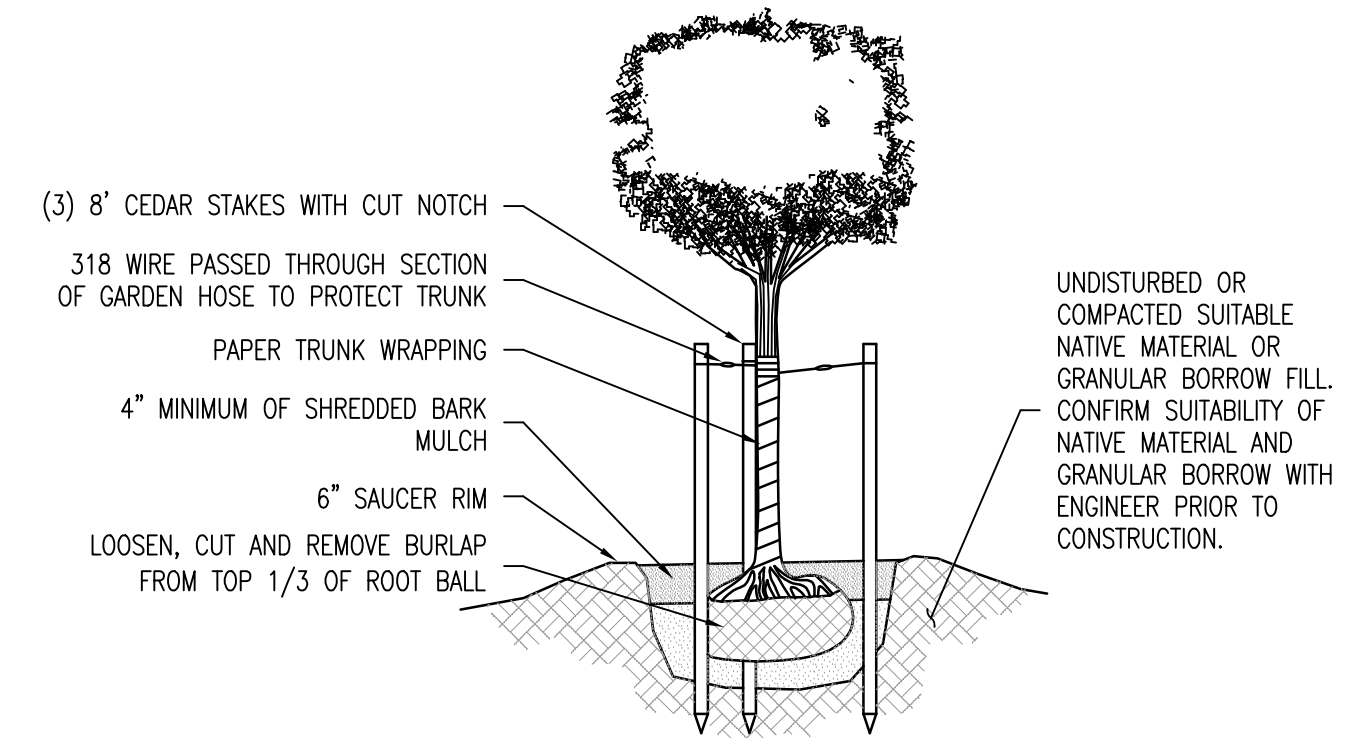

- NOTES:
1. GRANULAR BORROW FILL TO MEET AOT SPEC 703.04.
 2. PAPER TRUNK WRAP MUST BE REMOVED AFTER 1 YEAR.
 3. ROOT FLARES SHALL BE AT OR SLIGHTLY ABOVE FINISHED GRADE.
 4. AREAS TO BE PLANTED THAT ARE CURRENTLY PAVED SHOULD HAVE CONTINUOUS PLANTING PITS WITH LOAM OR SANDY LOAM PLANTING SOIL TO A DEPTH OF 2' MINIMUM TO SUPPORT TREE ROOT GROWTH.
 5. IN ADDITION TO THIS DETAIL, ALL TREE PLANTINGS SHALL BE PERFORMED IN ACCORDANCE WITH ANY PLANTING PROVIDERS REQUIREMENTS.

TREE PLANTING DETAIL

10
C3.0

N.T.S.

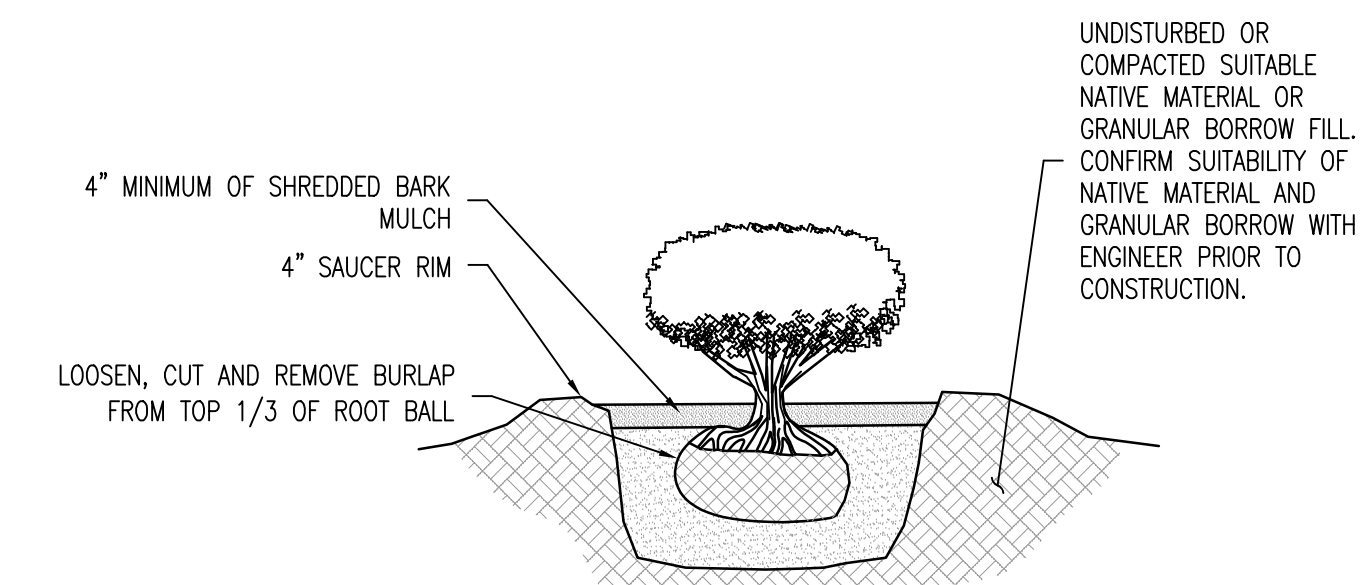

- NOTES:
1. GRANULAR BORROW FILL TO MEET AOT SPEC 703.04.
 2. AREAS TO BE PLANTED THAT ARE CURRENTLY PAVED SHOULD HAVE CONTINUOUS PLANTING PITS WITH LOAM OR SANDY LOAM PLANTING SOIL TO A DEPTH OF 2' MINIMUM TO SUPPORT SHRUB ROOT GROWTH.
 3. IN ADDITION TO THIS DETAIL, ALL TREE PLANTINGS SHALL BE PERFORMED IN ACCORDANCE WITH ANY PLANTING PROVIDERS REQUIREMENTS.

SHRUB PLANTING DETAIL

11
C3.0

N.T.S.

OWNER:

Washington County
Mental Health Inc.
P.O. Box 647
Montpelier, VT 05601-0647

PROJECT:

Proposed
Maintenance
Facility
225 VT RTE 14S
East Montpelier, VT 05651

SHEET TITLE:

Proposed
Site Details
Plan

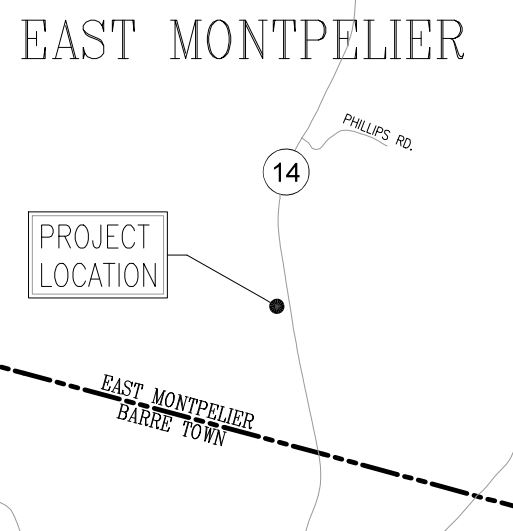

LOCATION MAP 1" = ±2,000'

☐ PRELIMINARY
☒ FOR PERMITTING
☐ NOT FOR CONSTRUCTION
☐ FOR CONSTRUCTION

PROJECT NO.: 18011		
DATE: JUNE 22, 2018		
SCALE: AS SHOWN		
REV. NO.	DESCRIPTION	DATE
1	REV'S PER AOT COMMENTS	7/23/18
2		
3		
4		
5		
6		
7		
8		
9		
10		

SHEET NUMBER:

C3.0

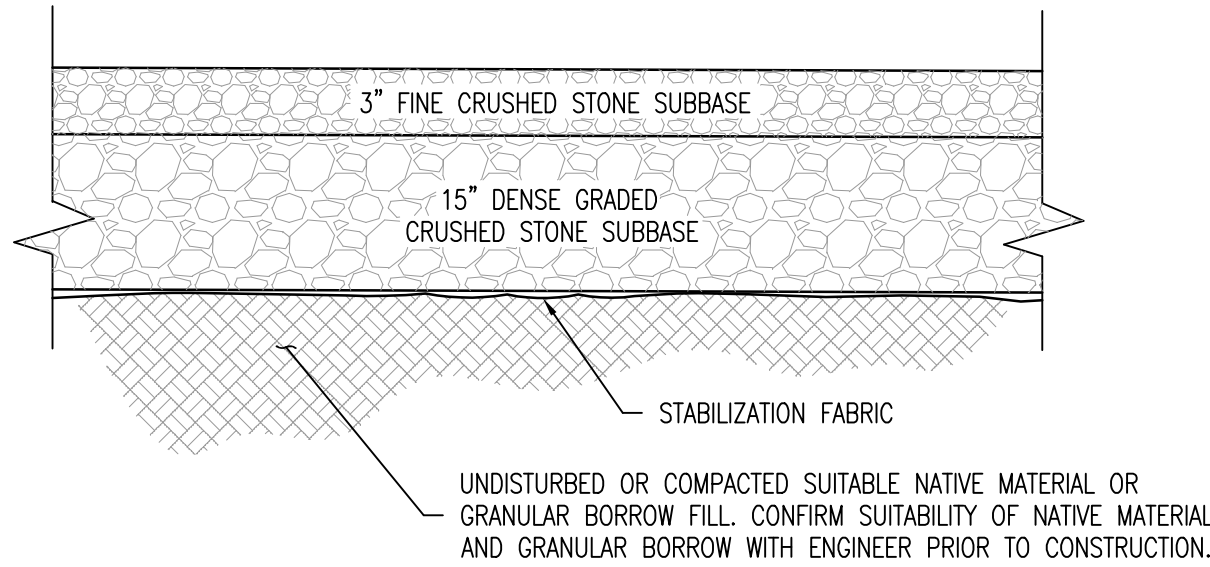

- NOTES:
1. FINE CRUSHED STONE AND DENSE GRADED CRUSHED STONE TO MEET AOT SPECS 704.05 AND 704.06 RESPECTIVELY.
 2. STABILIZATION FABRIC TO MEET AOT SPEC 720.04 FOR GEOTEXTILE FOR ROADBED SEPARATOR.
 3. SUBBASE TO BE INSTALLED IN ACCORDANCE WITH AOT SPECS 301 AND 406, RESPECTIVELY. SAND BORROW, WHERE REQUIRED, SHALL MEET AOT SPEC 703.03.
 4. GRANULAR BORROW FILL TO MEET AOT SPEC 703.04.
 5. COMPACTION OF SUBBASE MATERIALS TO MEET AOT SPEC 301.06.

DRIVEWAY SECTION DETAIL

1
C3.1

N.T.S.

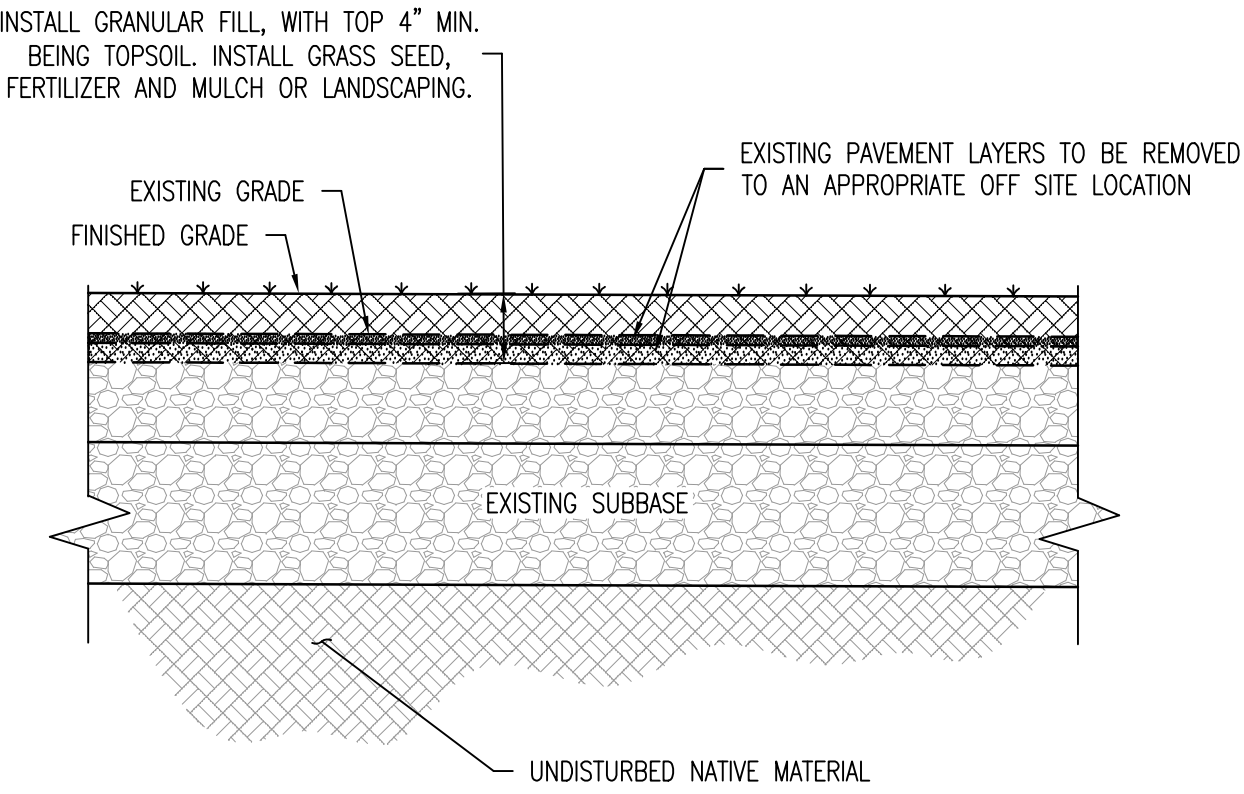

- NOTES:
1. GRANULAR FILL TO MEET AOT SPEC 703.04.
 2. COMPACTION OF SUBBASE MATERIALS TO MEET AOT SPEC 301.06.

PAVEMENT RECLAMATION DETAIL

2
C3.1

N.T.S.

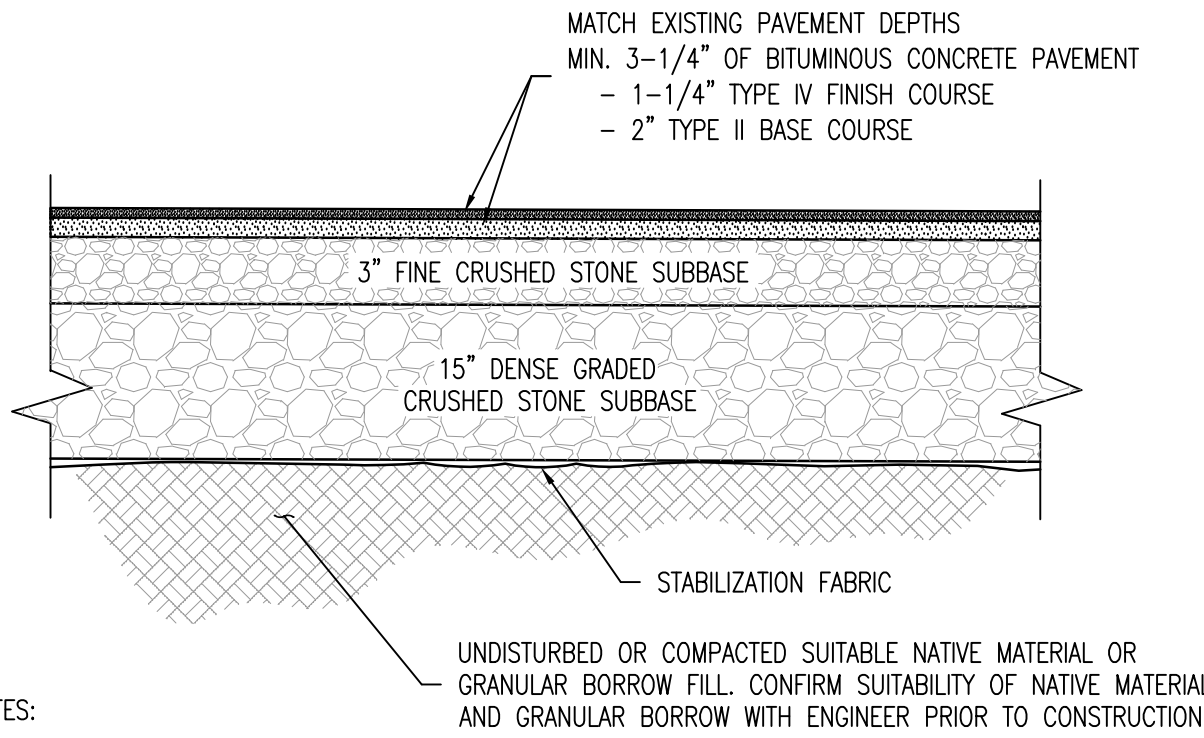

- NOTES:
1. BITUMINOUS CONCRETE PAVEMENT TO MEET AOT SPECS 704.10 AND 406.03(a).
 2. FINE CRUSHED STONE AND DENSE GRADED CRUSHED STONE TO MEET AOT SPECS 704.05 AND 704.06 RESPECTIVELY.
 3. STABILIZATION FABRIC TO MEET AOT SPEC 720.04 FOR GEOTEXTILE FOR ROADBED SEPARATOR.
 4. SUBBASE AND PAVEMENT TO BE INSTALLED IN ACCORDANCE WITH AOT SPECS 301 AND 406, RESPECTIVELY. SAND BORROW, WHERE REQUIRED, SHALL MEET AOT SPEC 703.03.
 5. GRANULAR BORROW FILL TO MEET AOT SPEC 703.04.
 6. COMPACTION OF SUBBASE MATERIALS TO MEET AOT SPEC 301.06.

FULL DEPTH CONSTRUCTION PAVING DETAIL

3
C3.1

N.T.S.

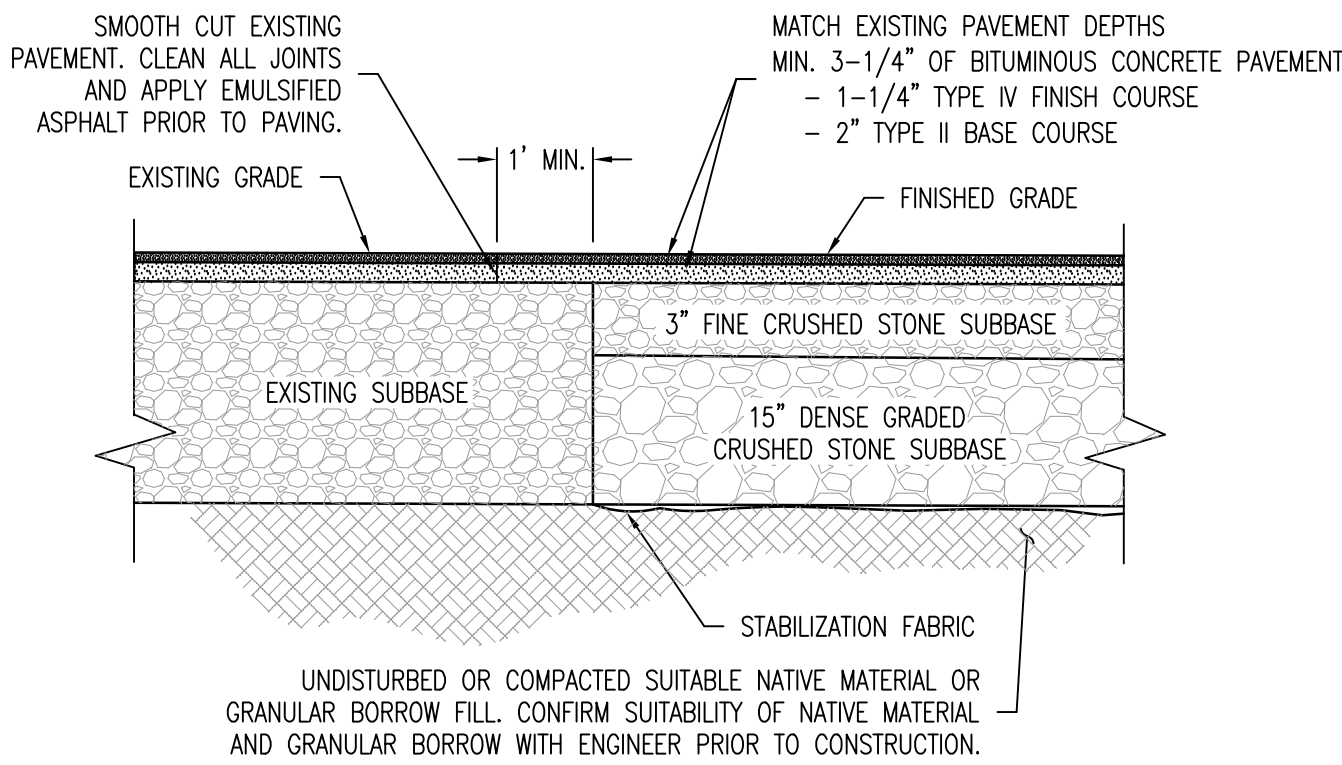

- NOTES:
1. BITUMINOUS CONCRETE PAVEMENT TO MEET AOT SPECS 704.10 AND 406.03(a).
 2. FINE CRUSHED STONE AND DENSE GRADED CRUSHED STONE TO MEET AOT SPECS 704.05 AND 704.06 RESPECTIVELY.
 3. STABILIZATION FABRIC TO MEET AOT SPEC 720.04 FOR GEOTEXTILE FOR ROADBED SEPARATOR.
 4. EMULSIFIED ASPHALT TO MEET AOT SPEC 702.04.
 5. SUBBASE AND PAVEMENT TO BE INSTALLED IN ACCORDANCE WITH AOT SPECS 301 AND 406, RESPECTIVELY.
 6. COMPACTION OF SUBBASE MATERIALS TO MEET AOT SPEC 301.06.

TIE INTO EXISTING PAVEMENT DETAIL

4
C3.1

N.T.S.

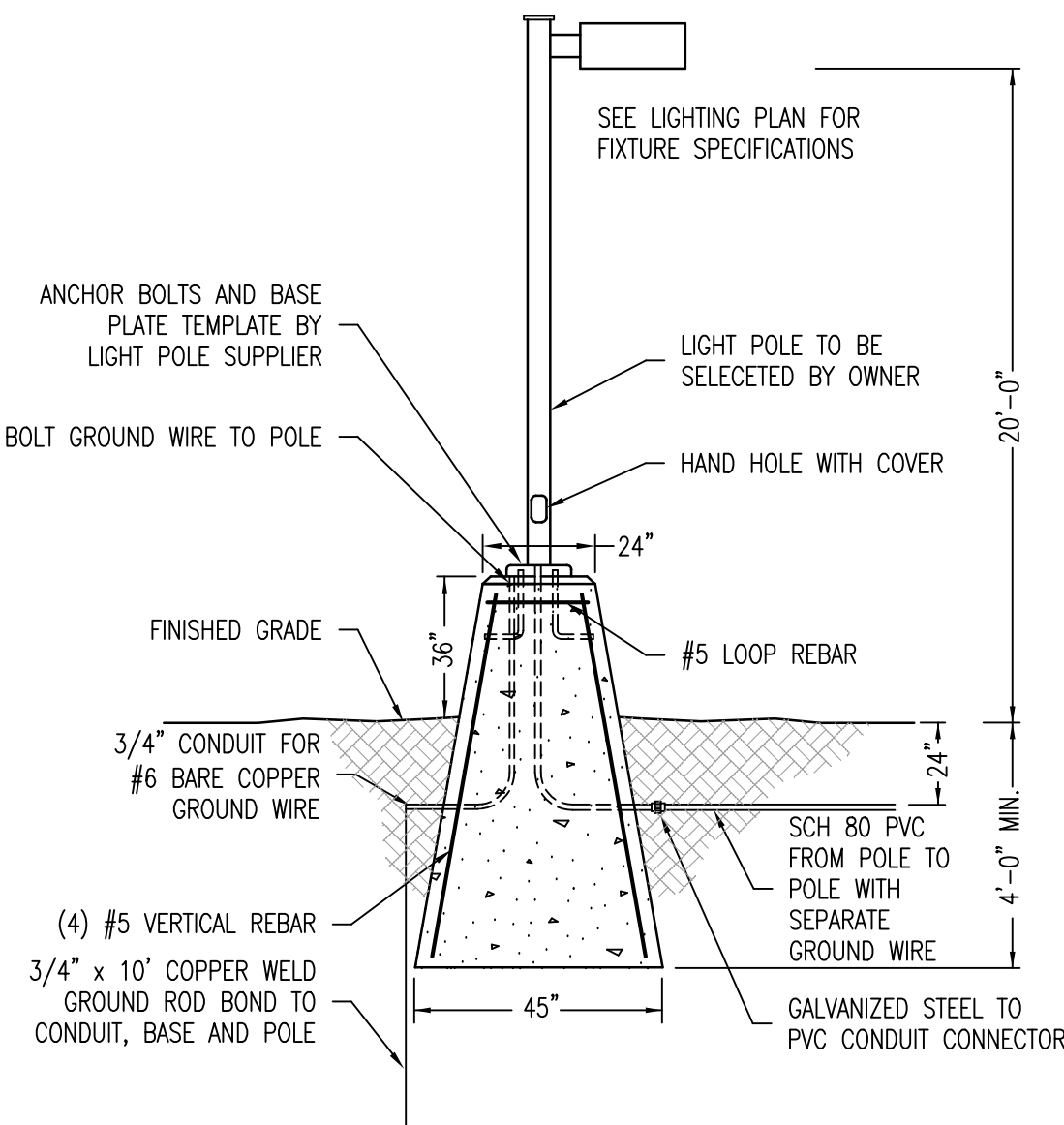

LIGHT POLE BASE DETAIL

5
C3.1

N.T.S.

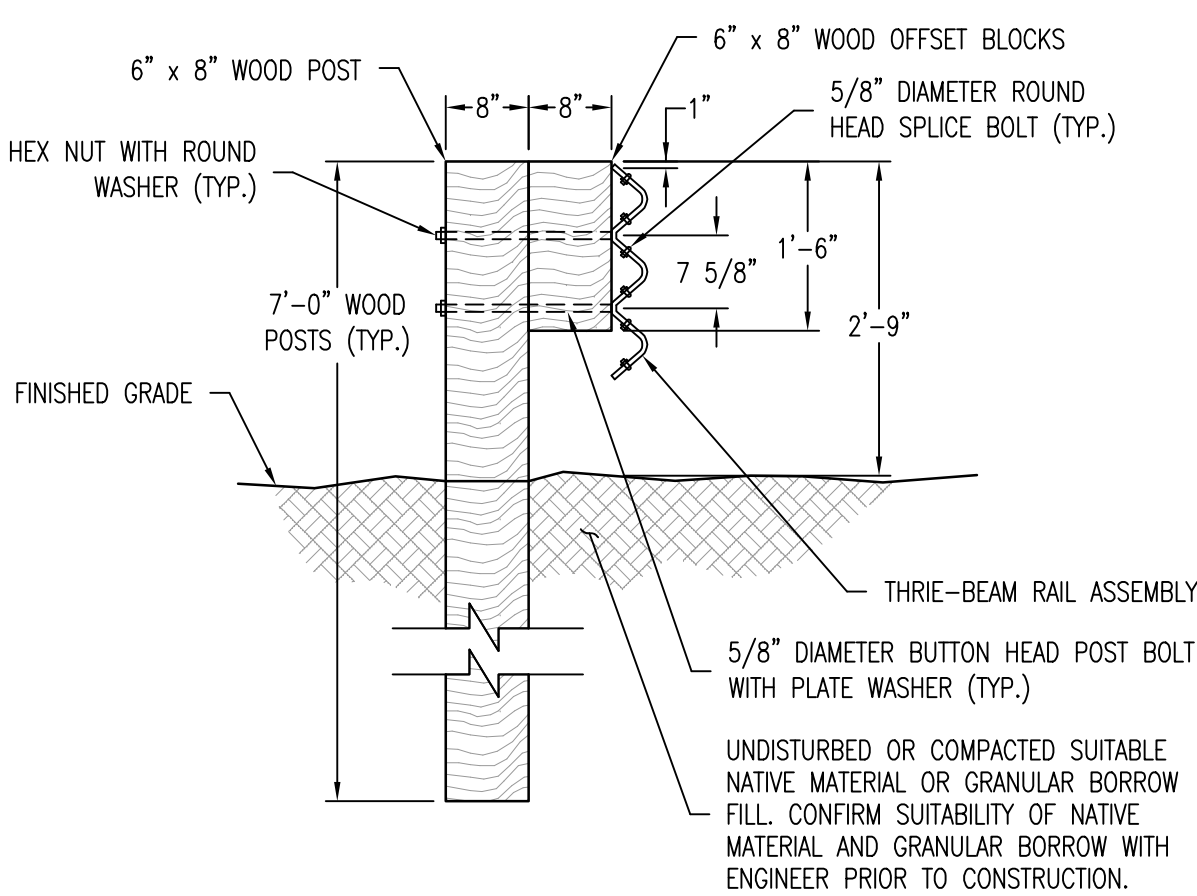

- NOTES:
1. GUARD RAIL MATERIALS TO COMPLY WITH AOT SPEC SECTION 728. RAIL ASSEMBLY TO BE INSTALLED IN ACCORDANCE WITH AOT STANDARD CONSTRUCTION SPEC S-363.
 2. GRANULAR BORROW FILL TO MEET AOT SPEC 703.04.
 3. COMPACTION OF MATERIALS TO MEET AOT SPEC 301.06.

GUARD RAIL DETAIL

6
C3.1

N.T.S.

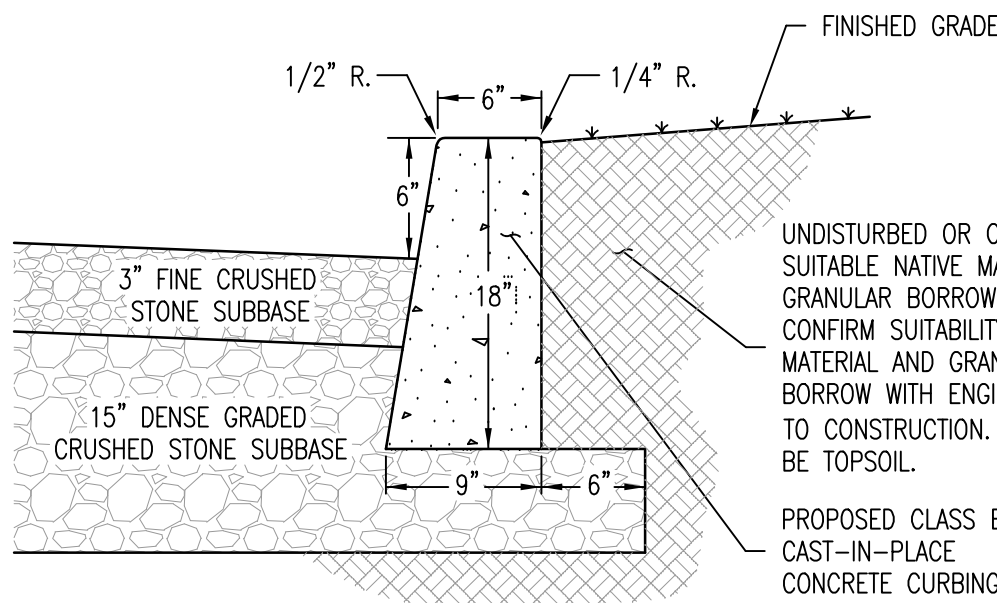

- NOTES:
1. CONCRETE FOR CURBING TO MEET AOT SPEC 541, CLASS B, AND SHALL BE INSTALLED IN ACCORDANCE WITH AOT SPEC 616.06. CURBING SHALL BE CONSTRUCTED IN 10' SECTIONS, WITH 1/8" JOINT BETWEEN SECTIONS. CURBING EXPANSION JOINTS SHALL BE CONSTRUCTED EVERY 20' AND CONSTRUCTED WITH PREFORMED JOINT FILLER TO MEET AOT SPEC 707.08.
 2. GRANULAR BORROW FILL TO MEET AOT SPEC 703.04.
 3. COMPACTION OF MATERIALS TO MEET AOT SPEC 301.06.

CONCRETE CURBING DETAIL

7
C3.1

N.T.S.

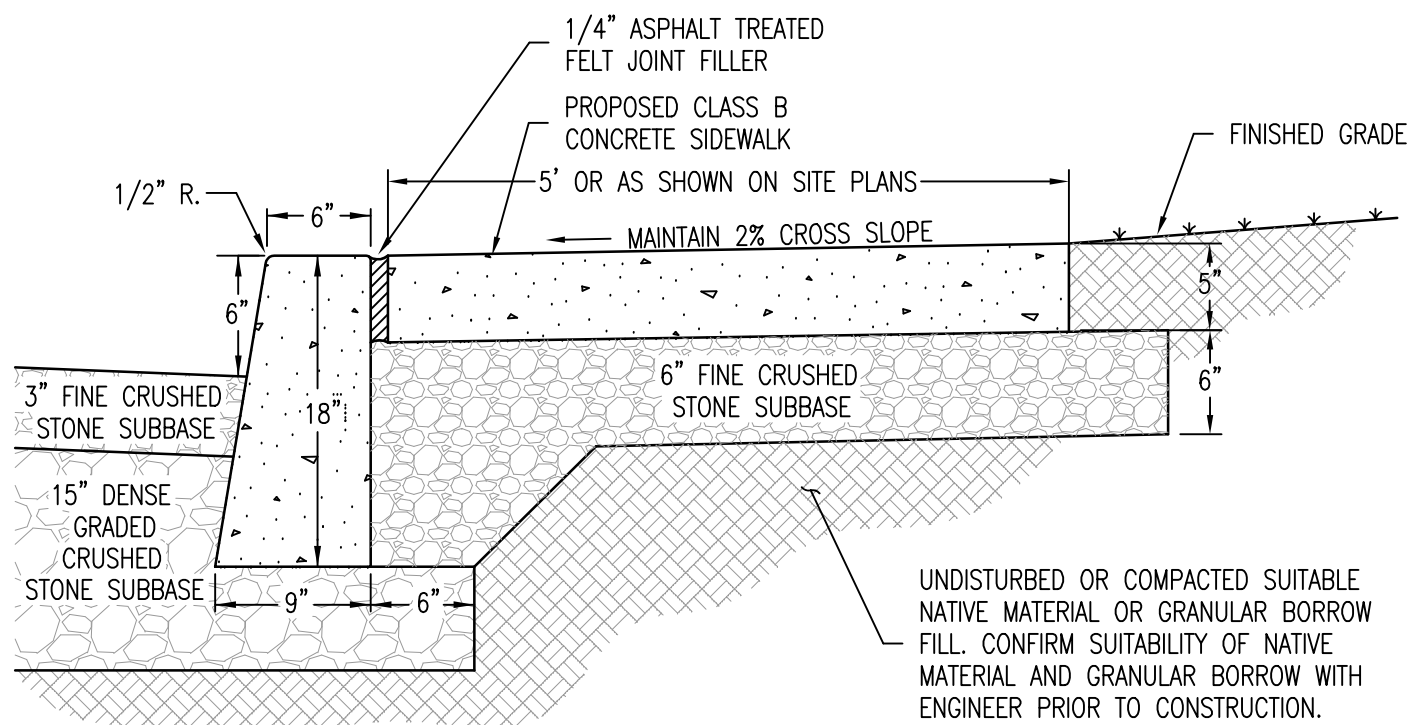

- NOTES:
1. CONCRETE FOR SIDEWALK TO MEET AOT SPEC 541, CLASS B, AND SHALL BE INSTALLED IN ACCORDANCE WITH AOT SPEC 618.03. SIDEWALK SHALL BE CONSTRUCTED IN 10' SECTIONS, WITH 1/8" JOINT BETWEEN SECTIONS. SIDEWALK EXPANSION JOINTS SHALL BE CONSTRUCTED EVERY 20' AND CONSTRUCTED WITH JOINT FILLER TO MEET AOT SPEC 707.08. SIDEWALK RAMPS AND DETECTABLE WARNINGS TO BE INSTALLED IN ACCORDANCE WITH AOT STANDARD C-3A.
 2. FINE CRUSHED STONE TO MEET AOT SPEC 704.05.
 3. ASPHALT TREATED FELT TO BE USED BETWEEN SIDEWALK AND CONCRETE CURB TO MEET AOT SPEC 707.08.
 4. GRANULAR BORROW FILL TO MEET AOT SPEC 703.04.
 5. COMPACTION OF MATERIALS TO MEET AOT SPEC 301.06.
 6. SIDEWALKS SHALL BE 5" THICK, EXCEPT WHERE IT CROSSES THE PROJECT DRIVEWAY, WHICH SHALL BE 8" THICK.

CONCRETE SIDEWALK DETAIL

8
C3.1

N.T.S.

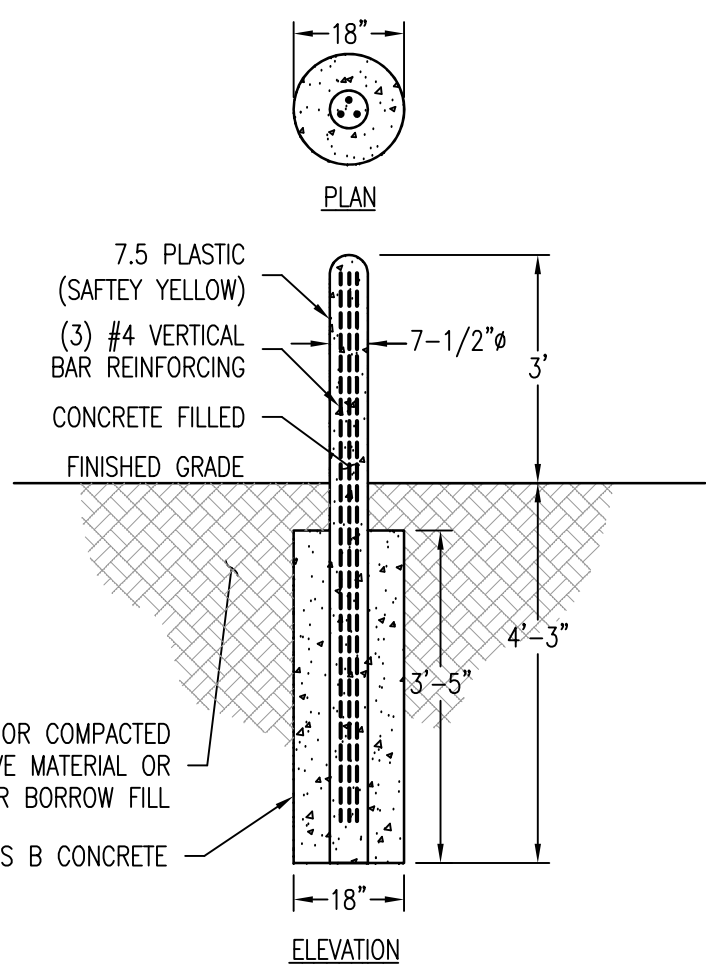

- NOTES:
1. CONCRETE TO MEET AOT SPEC 541, CLASS B.
 2. GRANULAR BORROW FILL TO MEET AOT SPEC 703.04.
 3. COMPACTION OF MATERIALS TO MEET AOT SPEC 301.06.

PRECAST BOLLARD DETAIL

9
C3.1

N.T.S.

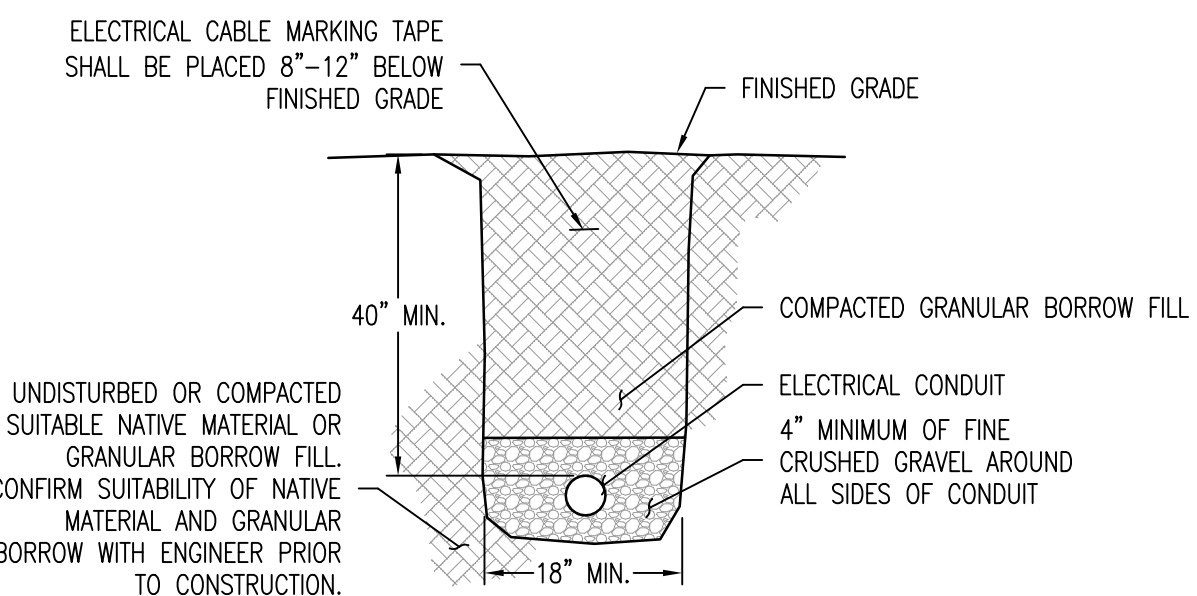

- NOTES:
1. ALL MATERIALS AND INSTALLATION PROCEDURES FOR SLEEVES FOR ELECTRICAL, TELEPHONE AND COMMUNICATION SERVICES SHALL MEET AOT SPEC 625.
 2. FINE CRUSHED GRAVEL TO MEET AOT SPEC 704.05.
 3. GRANULAR BORROW FILL TO MEET AOT SPEC 703.04.
 4. COMPACTION OF MATERIALS TO MEET AOT SPEC 301.06.
 5. REFER TO ELECTRICAL PLAN FOR CONDUIT TYPE AND SCHEDULE AND CONFIRM CONDUIT REQUIREMENTS WITH LOCAL SERVICE PROVIDERS.
 6. CONDUIT SHALL BE ENCASED IN 4" OF CLASS B CONCRETE FOR PORTIONS INSTALLED UNDER THE ROADWAY OR WITHIN 10' OF WATER, SEWER, GAS AND/OR DRAINAGE CROSSINGS.

ELECTRICAL CONDUIT TRENCH DETAIL

10
C3.1

N.T.S.

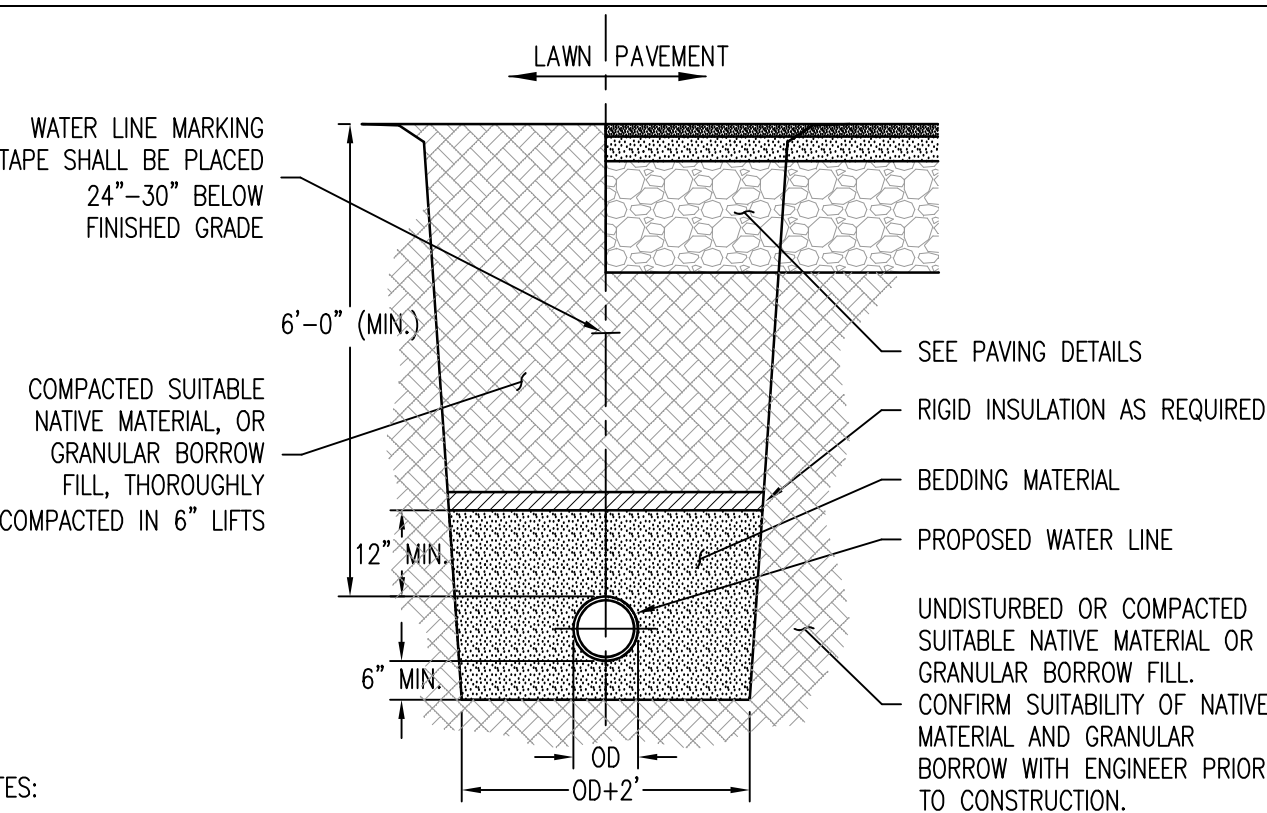

- NOTES:
1. WATER LINES, VALVES AND FITTINGS TO MEET AOT SPEC 740 AND BE INSTALLED AND TESTED IN ACCORDANCE WITH AOT SPEC 629.
 2. BEDDING MATERIAL SHALL BE SAND, GRAVEL OR CRUSHED STONE WITH NO STONES GREATER THAN 1". BEDDING MATERIAL SHALL NOT BE PLACED ON FROZEN SUBGRADE.
 3. IN TRENCHES WITH UNSTABLE MATERIALS, THE TRENCH BOTTOM SHALL BE STABILIZED WITH FILTER FABRIC AND 4" OF 3/4" CRUSHED STONE MEETING AOT SPEC 704.02B.
 4. GRANULAR BORROW FILL TO MEET AOT SPEC 703.04.
 5. WHEN 6' OF COVER CANNOT BE MAINTAINED INSTALL 2" OF RIGID INSULATION, FOR EVERY 1' OF COVER THAT CANNOT BE MAINTAINED, OVER THE PIPE EXTENDING A MINIMUM OF 2' BEYOND THE OUTER EDGES OF THE PIPE.

WATER TRENCH DETAIL

11
C3.1

N.T.S.

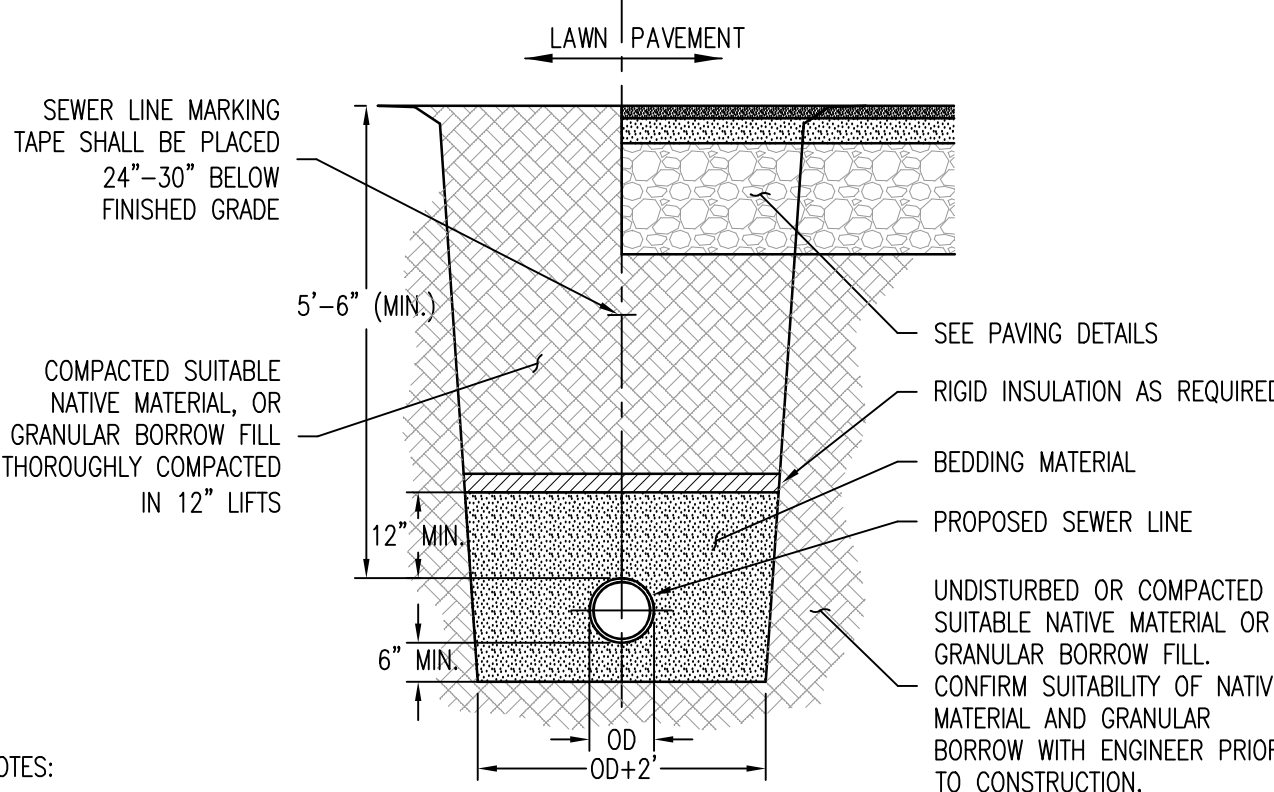

- NOTES:
1. SEWER LINES AND FITTINGS TO MEET AOT SPEC 710.06 AND BE INSTALLED AND TESTED IN ACCORDANCE WITH AOT SPEC 628.
 2. BEDDING MATERIAL SHALL BE 3/4" CRUSHED STONE MEETING AOT SPEC 704.02B. BEDDING MATERIAL SHALL NOT BE PLACED ON FROZEN SUBGRADE.
 3. IN TRENCHES WITH UNSTABLE MATERIALS, THE TRENCH BOTTOM SHALL BE STABILIZED WITH FILTER FABRIC AND 4" OF 3/4" CRUSHED STONE MEETING AOT SPEC 704.02B.
 4. GRANULAR BORROW FILL TO MEET AOT SPEC 703.04.
 5. WHEN 6' OF COVER CANNOT BE MAINTAINED INSTALL 2" OF RIGID INSULATION, FOR EVERY 1' OF COVER THAT CANNOT BE MAINTAINED, OVER THE PIPE EXTENDING A MINIMUM OF 2' BEYOND THE OUTER EDGES OF THE PIPE.

SEWER TRENCH DETAIL

12
C3.1

N.T.S.

OWNER:

Washington County
Mental Health Inc.
P.O. Box 647
Montpelier, VT 05601-0647

PROJECT:

Proposed
Maintenance
Facility
225 VT RTE 14S
East Montpelier, VT 05651

SHEET TITLE:

Proposed
Site Details
Plan

EAST MONTPELIER

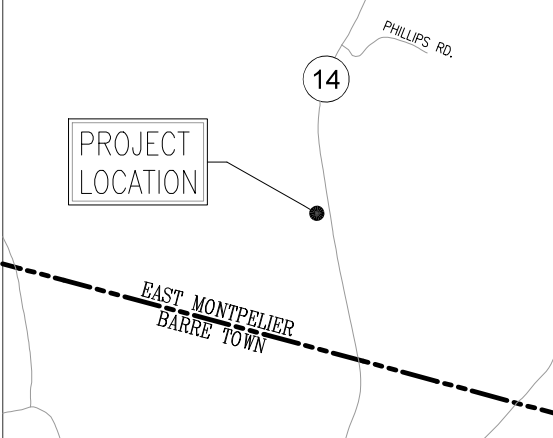

LOCATION MAP 1" = 1/2,000'

- ☐ PRELIMINARY
☒ FOR PERMITTING
☐ NOT FOR CONSTRUCTION
☐ FOR CONSTRUCTION

PROJECT NO.: 18011		
DATE: JUNE 22, 2018		
SCALE: AS SHOWN		
REV. NO.	DESCRIPTION	DATE
1	REV'S PER AOT COMMENTS	7/23/18
2		
3		
4		
5		
6		
7		
8		
9		
10		

SHEET NUMBER:

C3.1