

Permit # 20-005

ACCESS (CURB CUT) APPLICATION

Date Received: 3/19/20

Fee \$ 35 CK # 107

TOWN OF EAST MONTPELIER

Parcel # 05-050.000

PO Box 157, East Montpelier, VT 05651

Tax Map # 11-00-37.000

Applicant: FORREST TWOMBLY Phone: 793-1127

Mailing Address: PO BOX 218 ROXBURY, VT 05669

Property Owner: ROBERT & ENGINE COE Phone: 831-423-3990

Mailing Address: 10570 EMPIRE GRADE RD Santa Cruz CA 95060

Property Location: TOWNE HILL RD

PROJECT DESCRIPTION: sketch drawing and location map must be attached.

☒ CONSTRUCT A NEW ACCESS

☐ CHANGE AN EXISTING ACCESS

- ☐ agricultural
☐ commercial
☐ industrial
☒ residential
☐ development
☐ other

- Current Access:
☐ agricultural
☐ commercial
☐ industrial
☐ residential
☐ development
☐ other

- Proposed Access:
☐ agricultural
☐ commercial
☐ industrial
☐ residential
☐ development
☐ other

Distance, in feet, of the proposed access to the nearest intersection (specify the intersection):

+ 290' to MAPLEWOOD ROAD

Has the proposed access been flagged (i.e., marked) at the site? ☒ YES ☐ NO

Site must be flagged before the application will be considered.

The undersigned agree(s) to construct and maintain this access in accordance with applicable regulations and adhere to the specifications, restrictions, and conditions contained in this permit, if issued.

Applicant Forrest Twombly

Date 3/9/20

Property Owner Robert & Engine Coe

Date 3/9/2020

Property Owner Engine Coe

Date 3/9/2020

Denied: _____

Approval to Proceed: Upon receipt of this permit you are authorized to proceed with the project in accordance with the conditions, specifications and restrictions, including Road Foreman recommendations, contained in this document and any attachments to this document. Approval is granted only for the work described in this application and must be performed as directed. The Permit Holder shall be responsible for all damages to persons and/or property due to or resulting from any work allowed under this permit. The Permit Holder shall defend, indemnify and hold harmless the Town of East Montpelier and its officers, agents and employees from all suits, actions or claims of any character, name and description brought on account of any injuries or damages sustained by any person or property, including all costs or expenses to defend against such suits, actions or claims.

Date _____

SELECTBOARD _____

SELECTBOARD _____

SELECTBOARD _____

SELECTBOARD _____

SELECTBOARD _____

East Montpelier Access (Curb Cut) Application

Permit # 20-005

Road Foreman Determination:

☒ Proposed access meets applicable sight distance standards. Comments: _____

Road Foreman Recommendations:

Approved with existing culvert

Culvert/Drainage Requirements:

Roadway Culverts – 18" minimum diameter of metal, reinforced concrete, or polyethylene pipe with drop inlets or catch basins as required. Hydraulic Analysis to determine appropriate pipe diameter is recommended for all live stream crossings and elsewhere where large storm flows may be expected. See VTrans Standard A-76.

Driveway Culverts – Circular drainage culverts shall have a minimum inside cross-sectional area equivalent to that provided by a 15" circular pipe. See VTrans Standard B-71.

Underdrains – 6" minimum diameter of metal, PVC plastic or polyethylene pipe.

Road Foreman

3/26/20
Date

Additional Selectboard Conditions &/or Restrictions:

The East Montpelier Land Use & Development Regulations and the East Montpelier Road & Bridge Standards are incorporated by reference.

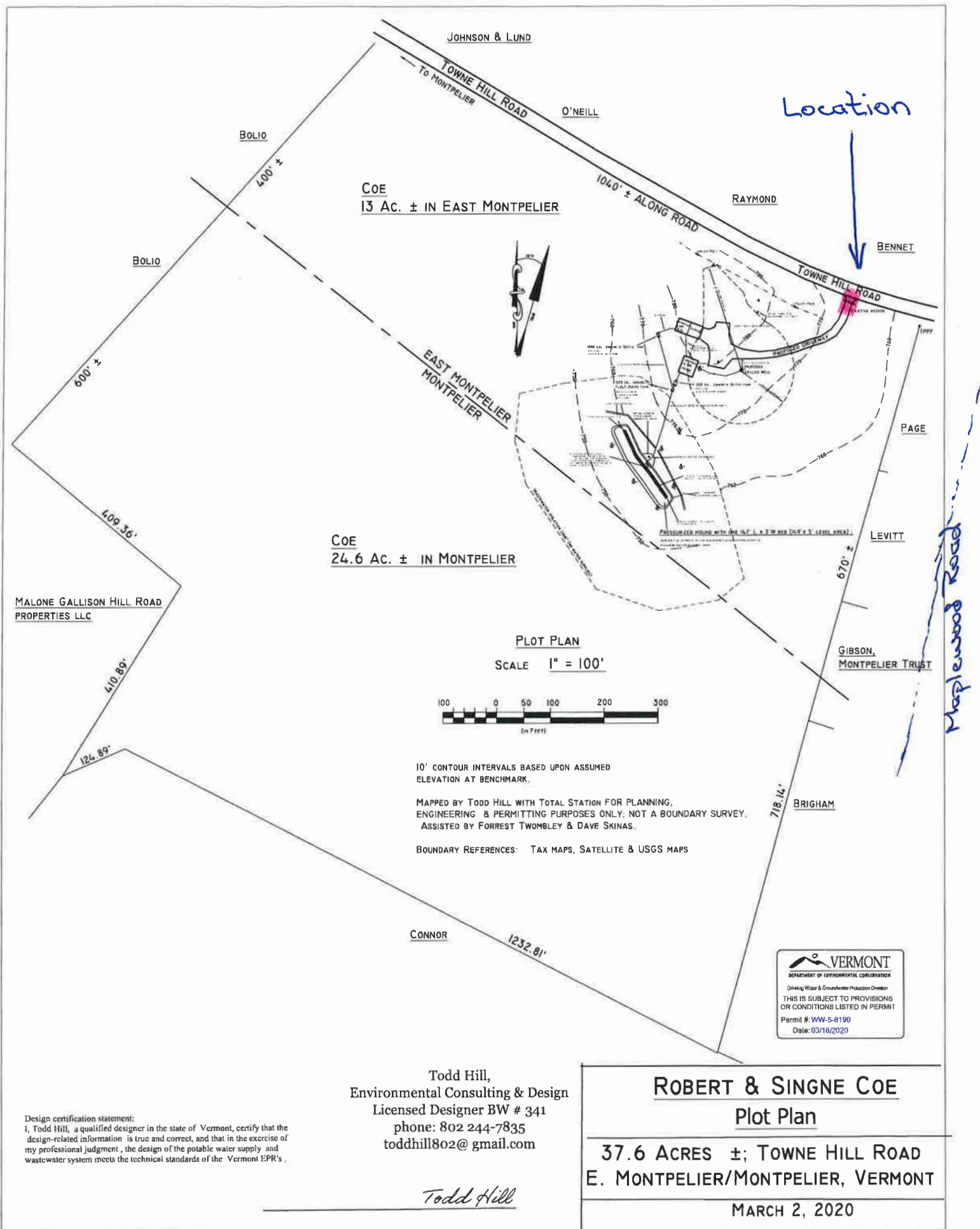



Coe -- 0 Towne Hill Road

East Montpelier, VT

1 inch = 613 Feet



March 20, 2020

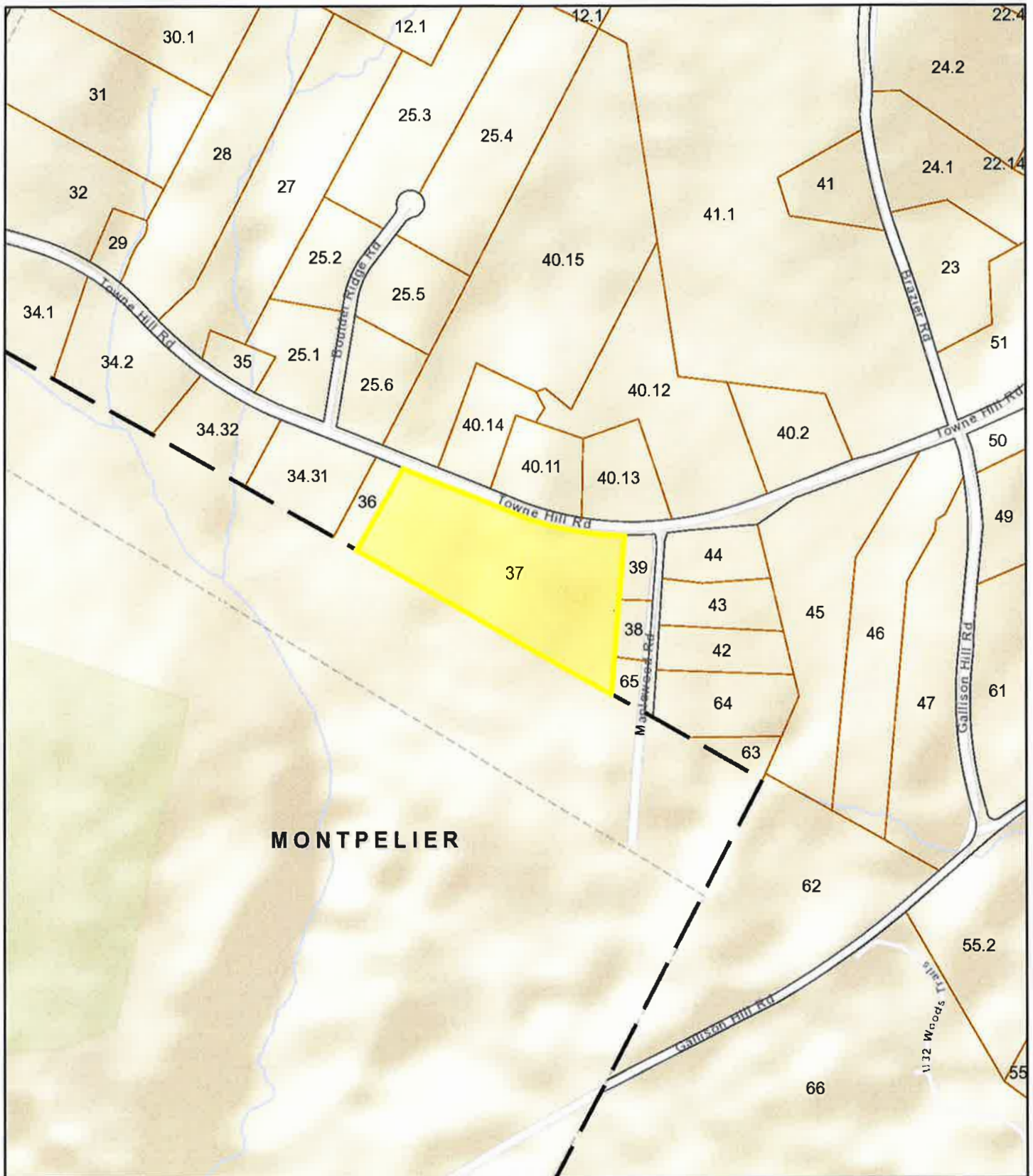

Data shown on this map is provided for planning and informational purposes only. The municipality and CAI Technologies are not responsible for any use for other purposes or misuse or misrepresentation of this map.