

Permit # 21-011

SIGN PERMIT APPLICATION

Date Received: 3/9/21

Zoning District C

TOWN OF EAST MONTPELIER

Parcel # 10-070.000

Overlays RC, SFHA

PO Box 157, East Montpelier, VT 05651

Tax Map # 21-52-42.000

A. 1. Name of Landowner Jason Lawrence Phone No. 802 595 5609

2. Address of Landowner 33 Maple Ave

3. Applicant (other than owner) Dani cain Phone No. 802 5222322

4. Address of Applicant 4304 East Hill Road Plainfield 05667

5. Location of Property 3070 Rt 2 East Montpelier

B. Sign Data:

1. Sign size (height & width): ~~8'x8'~~ triangle 8'x8'x4' 15 sq. ft.

2. Construction material: Pressure Treated # MDO

3. Lettering: One side only Both sides

4. Is sign lit: Yes No If yes, please describe Lettering of Fox Market will be back lit.

5. Free standing sign: Yes No If yes: Height from ground at peak 16'

Distance from road centerline 45'

Part of multi-sign platform: Yes No

6. Sign attached to building: Yes No If yes: Wall mounted Hanging

7. Sign consists of wall lettering &/or graphics: Yes No

Describe sign to be installed: Sign will stand off North west corner of building. It will be a triangle with notched back.

Part of sign will be the face of a fox and say Fox Market on the bottom. It will stand only tall enough to be seen from both sides easily, just about of eye.

Important: Please provide a picture, sketch, or some other visual depiction of the desired sign. Also, please provide a location sketch showing sign placement on the property and orientation to the nearest public road. If the sign is on a building, show both the location of the sign on the building and the building on the property.

READ CAREFULLY:

A zoning permit shall be required prior to the erection, construction or replacement of any outdoor sign, except for signs which are specifically exempted or specifically prohibited by the East Montpelier Land Use & Development Regulations.

The undersigned requests a zoning permit as described above, understanding that the permit will be voided and penalties imposed, if the sign is not completed as described. The permit will be voided if the sign is not erected within one year from date of issue. The undersigned hereby applies on the basis of the representations contained herein, and to the best of his/her knowledge believes them to be true.

Landowner [Signature] Date 2-18-21

Applicant [Signature] Date 03.08.21

Zoning Permit Fee: \$ 35.00 Cash Check #1002 Date 3/9/21 Rec'd by DS

DRB Hearing Fee: \$ Cash Check Date Rec'd by

Make checks payable to the "Town of East Montpelier"

Sign Design for Sign Permit at 3070 Rt. 2 East Montpelier

Sign Construction:

Frame of sign is to be built from 2x4 pressure treated lumber. Custom steel bracket to be installed at each joint on the inside of the sign. The two faces of the sign will be MDO. The lettering of Fox Market and Eyes, Ears and Nose will be routed out and backed with colored plexiglass. Exterior grade LED strip lights will be mounted to the interior of the sign outside the line of sight of the lettering to eliminate any glaring or bright spots. The outside of the sign will be edged with painted rolled steel with edges rolled to 3/8" larger than the width of the sign.

Post:

The post is to be constructed out of two 4x4 pressure treated posts, washed with a semi-transparent black stain. They will be mounted in a V shape with posts coming together at the bottom. They will be mounted with custom steel brackets constructed of 1/2" steel at both and top. Design and fabrication of mounting brackets will be done by Flywheel Industries. The post will be mounted to precast concrete footing to be installed by Farnam Contracting.

Sign Location

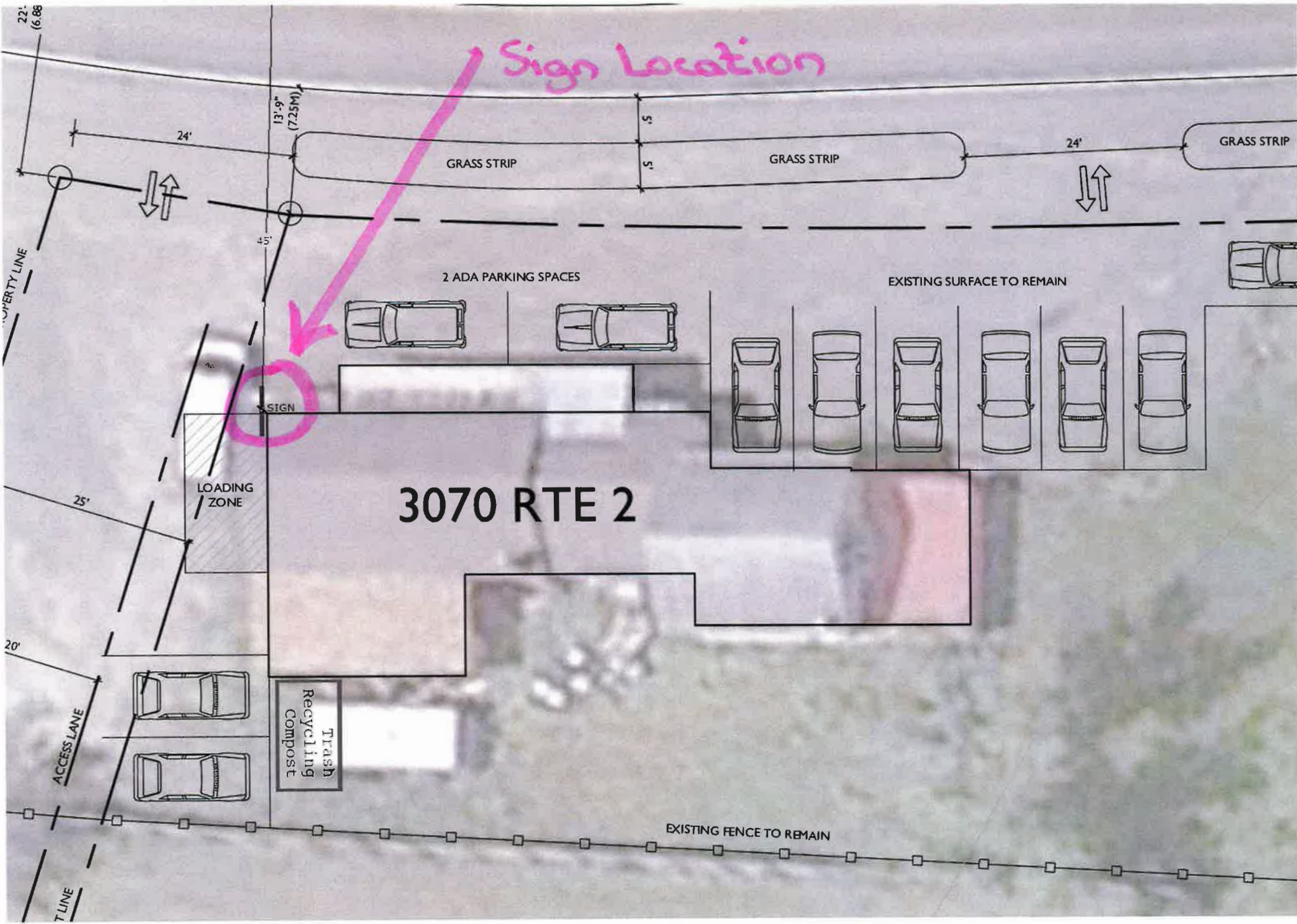

3070 RTE 2

Trash
Recycling
Compost

LOADING
ZONE

SIGN

GRASS STRIP

GRASS STRIP

GRASS STRIP

EXISTING SURFACE TO REMAIN

EXISTING FENCE TO REMAIN

ACCESS LANE

PROPERTY LINE

T LINE

